

FUNCTION EXTENSIONS VACUU-SELECT

User Management
SYNCHRO



Instructions for use



Original instructions Keep for further use!

This manual is only to be used and distributed in its complete and original form. It is strictly the user's responsibility to carefully check the validity of this manual with respect to the product.

Manufacturer:

VACUUBRAND GMBH + CO KG
Alfred-Zippe-Str. 4
97877 Wertheim
GERMANY

Phone:

Head office +49 9342 808-0
Sales +49 9342 808-5550
Service +49 9342 808-5660

Fax: +49 9342 808-5555

Email: info@vacuubrand.com

Web: www.vacuubrand.com

*Thank you for purchasing this product from **VACUUBRAND GMBH + CO KG**. You have chosen a modern and technically high quality product.*

TABLE OF CONTENTS

1	Introduction	5
1.1	User information	5
1.2	Display conventions	6
1.2.1	Notes	6
1.2.2	Operation gestures	6
1.2.3	Action instructions (operating steps)	7
1.2.4	Supplementary controls and symbols	7
1.3	Target group description	9
1.3.1	Personnel qualification	9
1.3.2	Responsibility matrix	9
2	Product description	10
2.1	Function extensions	10
2.1.1	Requirements	10
2.1.2	License file for unlocking function extensions	10
2.2	User Management	10
2.3	SYNCHRO	11
3	Function Extensions	12
3.1	Opening the Function Extensions menu	12
3.2	Requesting a license file	13
3.3	Unlocking function extensions	14
3.3.1	Via license code	14
3.3.2	Via USB flash drive	15
3.4	Deactivating function extensions	16
4	User Management	18
4.1	Creating an administrator password	18
4.2	User Accounts	19
4.2.1	Setting up and editing	19
4.2.2	Removing users	23
4.3	User groups	24
4.3.1	Setting up and editing	24
4.3.2	Editing a user group + context menu	27
4.3.3	Advanced Settings	29
4.4	User information	30
4.4.1	Switching users	30
4.4.2	Locking and unlocking (display)	32
4.4.3	Other context menus explained	33
4.5	Import/Export User Management	35
4.5.1	Export User Management + Applications	35
4.5.2	Import User Management + Applications	36
4.6	Login/logout	38
4.6.1	Login at start up	38
4.6.2	Auto start function	38
4.7	Password reset	39
4.7.1	User password	39
4.7.2	Administrator password	40

5	SYNCHRO	41
5.1	User interface	41
5.2	Error indication	44
6	Troubleshooting	45
6.1	Function Extensions	45
6.2	User Management	45
6.3	SYNCHRO	46
7	Appendix	47
8	Index	48

1 Introduction

This document describes the general aspects of the function extensions that you have purchased. For additional descriptions about operation, please read the user manual of your controller.

1.1 User information

Safety

- Read the user manual before using the product.
- Store the user manual where it is accessible and within reach at all times.
- Correct use of the product is essential for safe operation. Observe all safety information!
- In addition to the information in this manual, please observe the applicable national regulations on accident prevention and work safety.

General

- To improve readability, the general term *controller* is used in place of the product names *VACUU-SELECT* and *VACUU-SELECT complete*.
- The figures and drawings are examples and are only intended to assist in comprehension.
- Products are subject to technical and design changes without notice in the context of continuous product improvement.

Copyright

The content of this user manual is protected by copyright. Making copies for internal purposes is permitted; e.g. for training courses.

© VACUUBRAND GMBH + CO KG

1.2 Display conventions

1.2.1 Notes

NOTE

Reference to a potentially harmful situation.

Non-observance may result in material damage.

Supplementary notes

IMPORTANT!

- ⇒ Description that you must adhere to when performing actions.
- ⇒ Important information for the proper operation of your product.



- ⇒ Tips + tricks
- ⇒ Helpful information

1.2.2 Operation gestures

Gesture symbols

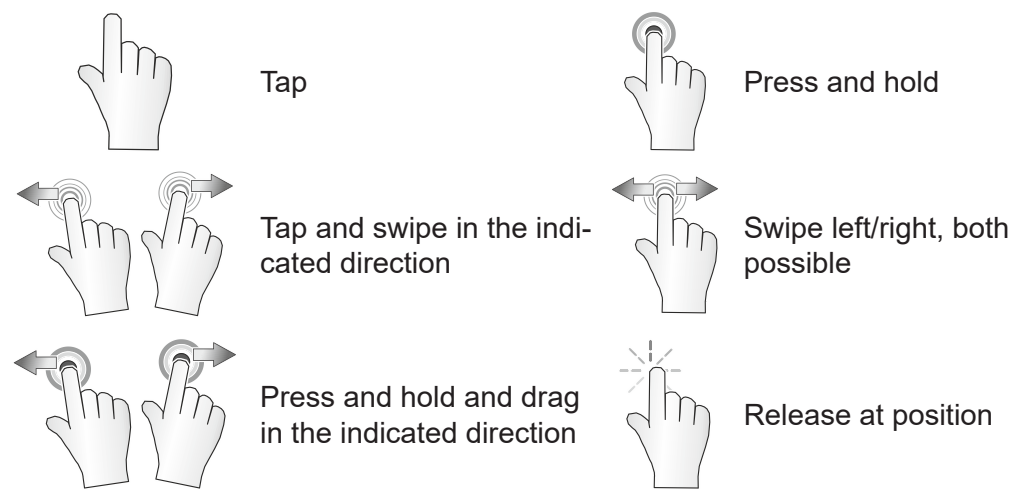

1.2.3 Action instructions (operating steps)

Operating steps displayed as text

Action instructions (easy)

⇒ You are prompted to perform an action.

- Result of the action

Action instructions (multiple steps)

1. First action step
2. Next action step

- Result of the action

Action instructions that require several steps must be followed in the order described.

Action instructions (presented graphically)

Principle display graphical operating steps

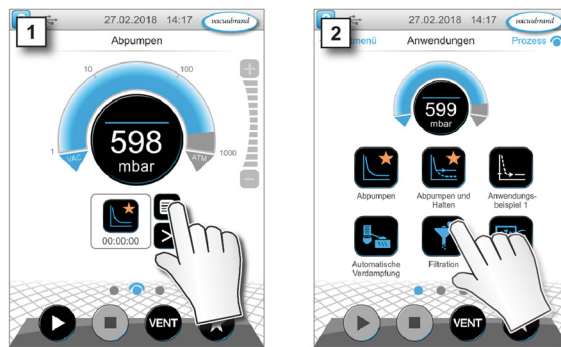



1. First action step
 2. Next action step
- Result of the action

1.2.4 Supplementary controls and symbols



Status bar

Meaning of new symbols in the status bar

Symbol (icon)	Meaning
	<p>Help</p> <ul style="list-style-type: none"> ▶ Supplementary description of Function Extensions. ▶ Supplementary description of User Management.
	<p>User Options</p> <ul style="list-style-type: none"> ▶ Display user information for logged-in users. ▶ Log out user. ▶ Change password. ▶ Lock device. ▶ User Options are only shown if User Management has been unlocked and activated.
	<p>USB connected</p> <ul style="list-style-type: none"> ▶ Indicates that a USB storage device is connected.

Buttons – function extensions menu

Meaning of buttons in
Function Extensions
menu

Symbol (icon)	Meaning
	<p>Unlock Information</p> <ul style="list-style-type: none"> ▶ Procedure for acquiring a license for your controller. ▶ Serial number and manufacturing date of the controller.
	<p>Function Unlocking</p> <ul style="list-style-type: none"> ▶ Function button for assisted unlocking. ▶ License code entry or unlocking via USB flash drive.
	<p>Function Activation</p> <ul style="list-style-type: none"> ▶ Activate unlocked function extensions (for some function extensions, a password may be required after restart). ▶ Deactivate unlocked function extensions.





Buttons – administration menu

Meaning of button in
Administration menu

Symbol (icon)	Meaning
	<p>User Management menu</p> <ul style="list-style-type: none"> ▶ Create and manage users and user groups. ▶ Define login options.

Buttons – User Management menu

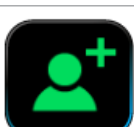
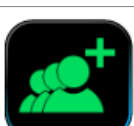
Meaning of buttons in
User Management

Symbol (icon)	Meaning
	<p>User Accounts overview</p> <ul style="list-style-type: none"> ▶ Predefined users: administrator, default user. Predefined users cannot be deleted. ▶ User accounts created.
	<p>User Groups overview</p> <ul style="list-style-type: none"> ▶ Predefined user groups: administrators, default group. Predefined user groups cannot be deleted. ▶ User groups created.
	<p>Create User Account</p> <ul style="list-style-type: none"> ▶ Set a user name and password. ▶ Assignment to a user group.
	<p>Create User Group</p> <ul style="list-style-type: none"> ▶ Set a group name. ▶ Assign shared applications and authorization settings.
	<p>Advanced Settings</p> <ul style="list-style-type: none"> ▶ Setting options: Set default user off/on, auto login off/on and password complexity.

1.3 Target group description

IMPORTANT!

Users of the competence areas listed in the *Responsibility matrix* must have the appropriate qualifications for the listed activity.

1.3.1 Personnel qualification

Administrator	User with extended authorizations.
Default user	User with assigned authorizations.

1.3.2 Responsibility matrix

Responsibility matrix and competency areas

Activity	Administrator	Default user
Unlock function extensions	x	
Create users/user groups	x	
User management + export/import applications	x	(x)
Assign access rights	x	
Create passwords	x	
Reset passwords	x	
Unlocked operation		x

2 Product description

2.1 Function extensions

Product description of function extensions in the controller

From software version V1.06 / V1.00, the VACUU SELECT vacuum controller offers the option of unlocking additional function extensions; e.g., User Management.

Controllers with earlier software versions can be equipped for unlocking function extensions by performing a [software update](#).

A device-dependent license is required to unlock a specific function extension. The license contains an individual license file as well as a license code for the desired function extension and is created on the basis of the serial number and the manufacturing date of the controller.

The function extension can be unlocked using the provided license file on a USB flash drive or by entering the license code via the on-screen keyboard.

Unlocked function extensions can be deactivated again at any time in the **Function Extensions** menu.

2.1.1 Requirements

Supported software version

Software from version V1.06 / V1.00 onwards is required to use function extensions.

⇒ If necessary, perform a [software update](#) of the vacuum controller.

Acquiring a license

License to unlock function extensions.

⇒ For further information on function extensions, please contact the Sales team at **VACUUBRAND**¹.

2.1.2 License file for unlocking function extensions

Unlocking with license code

If you have a valid license, please follow the set-up assistant that appears after you insert the USB flash drive containing the license file. Alternatively, you can enter the license code using the on-screen keyboard.

→ See also Chapter: **3.3 Unlocking function extensions**

2.2 User Management

User Management function extension

VACUU·SELECT User Management is a function extension of the VACUU·SELECT interactive vacuum controller. User authorizations can be flexibly customised to meet the requirements of the respective customer.

When creating user groups, different users can be configured with different authorizations.

Advantages of User Management: efficient multiple use, ensures consistent process parameters and minimizes operating errors.

¹ [Contact](#) – material number: **Ordering information on page 47**

2.3 SYNCHRO

The SYNCHRO function is a functional extension for the interactive vacuum controller VACUU·SELECT.

With the SYNCHRO function, it is possible to control two processes in parallel with one single vacuum controller VACUU·SELECT.

The processes can run independently of each other and at the same time. This requires two sensors and two valves.

Thus, for example, two rotary evaporators can be handled with one VACUU·SELECT. Another option is to operate two tapping points in one fume cupboard. These can be tapping points for rough vacuum and fine vacuum.

3 Function Extensions

The Function Extensions sub menu enables you to unlock additional functions and activate/deactivate functions that are already unlocked.

To unlock function extensions you need a USB flash drive with a valid license file or a license code that can be entered via the on-screen keyboard.

3.1 Opening the Function Extensions menu

Opening the Function Extensions sub menu

→ Example
Process display



Tap



Press and
hold and drag



Press and
hold and drag

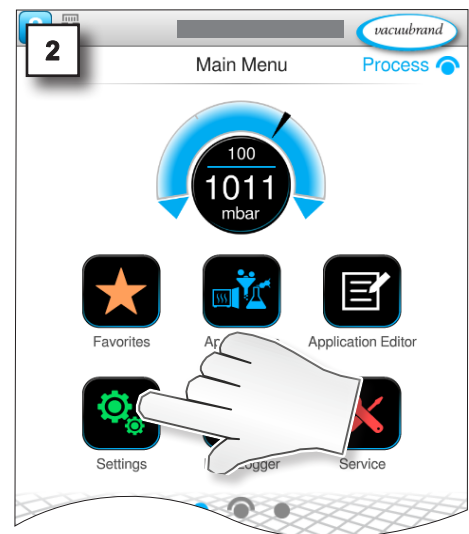
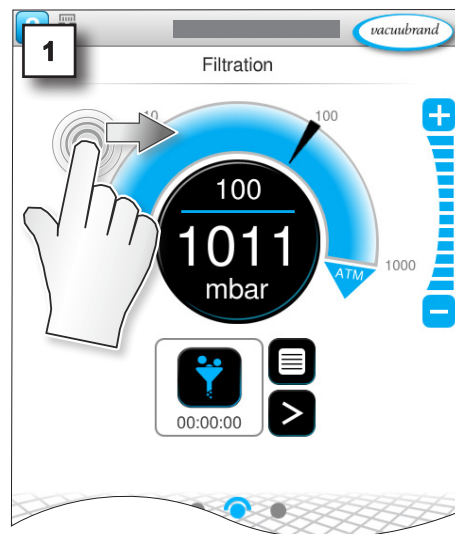

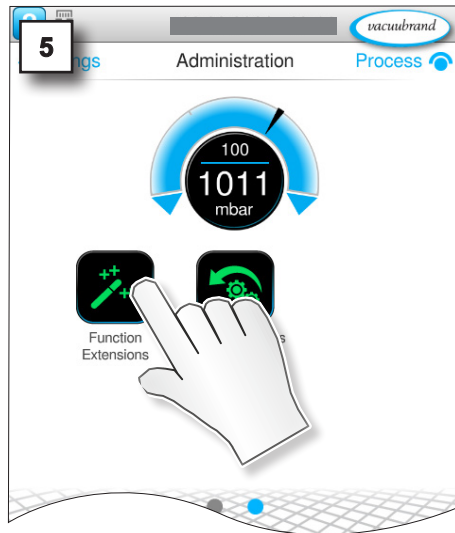

3.2 Requesting a license file

→ Example
Main Menu \ Settings \
Administration \ Function
Extensions



Tap

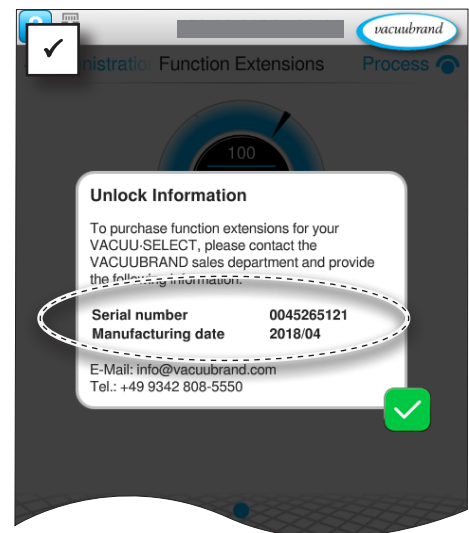
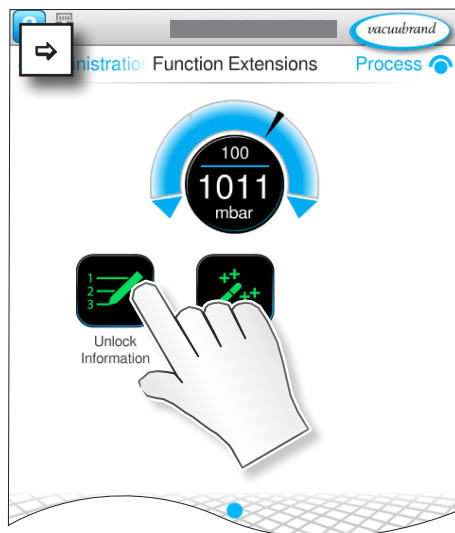

1. Make a note of the serial number and manufacturing date .

2. Provide this information when ordering the license .

You will receive the license code and a license file via e-mail .

IMPORTANT!

The license is linked to the controller by matching serial number and manufacturing date. The license can only be used on one controller.

⇒ Please proceed as described above if you would like to unlock function extensions for multiple controllers.

⇒ Provide the controller serial number and manufacturing date for each license.

3.3 Unlocking function extensions

3.3.1 Via license code

Entering a license code

→ Example
Main Menu \ Settings \
Administration \ Function
Extensions

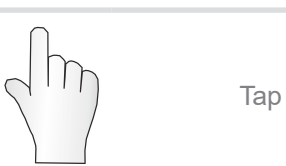

→ Example
Entering a license code
and confirming

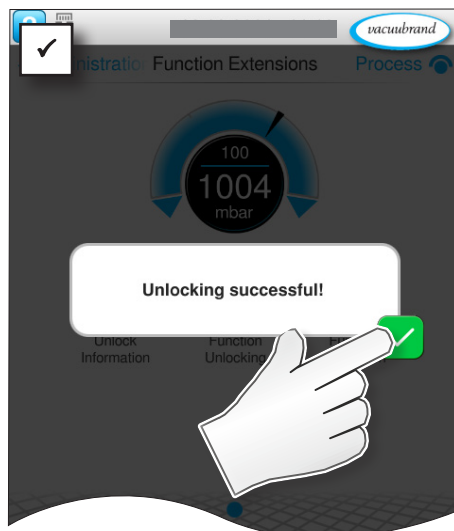
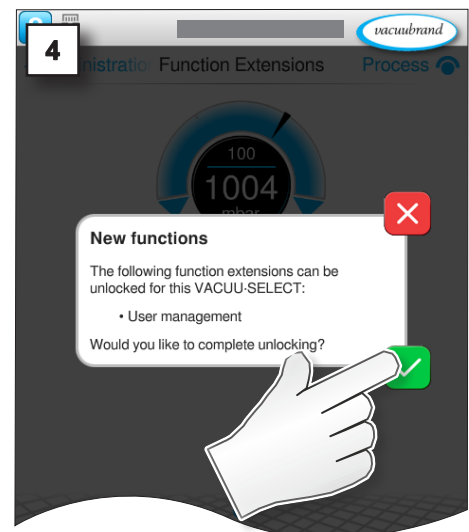
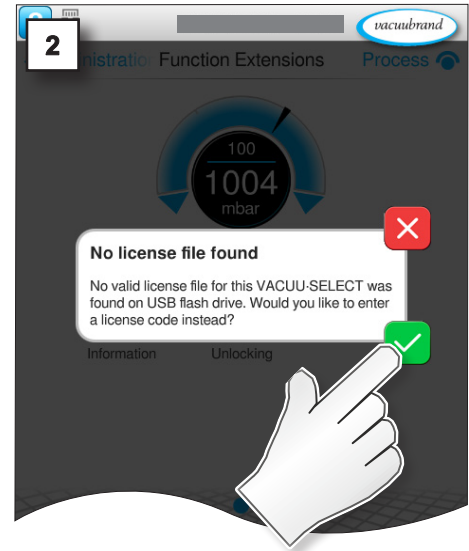

3.3.2 Via USB flash drive



If you would like to add a function extension for several controllers at the same time, then you can save all the license files that you obtain from us on a USB flash drive. Go to each controller with this USB flash drive and perform function unlocking for each one. By way of the stored serial number, the controller automatically detects the matching license for unlocking the function extensions.

Transferring the file via USB flash drive

→ Example
Main Menu \ Settings \
Administration \ Function
Extensions



Tap

1

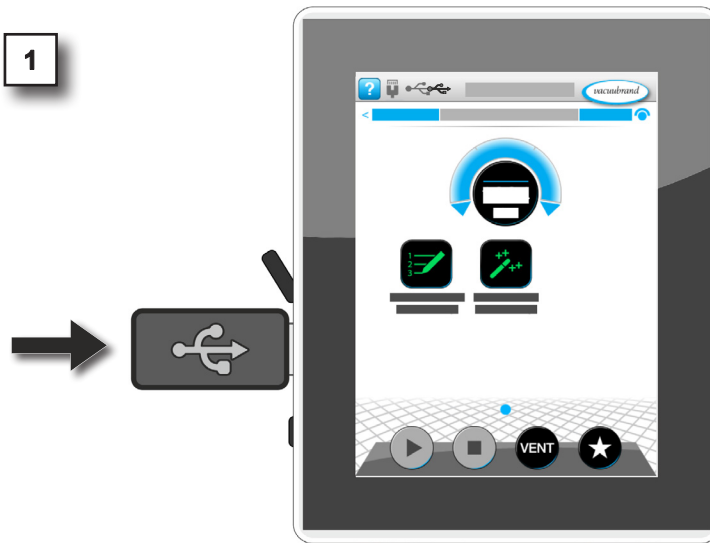

Cancel



Confirm

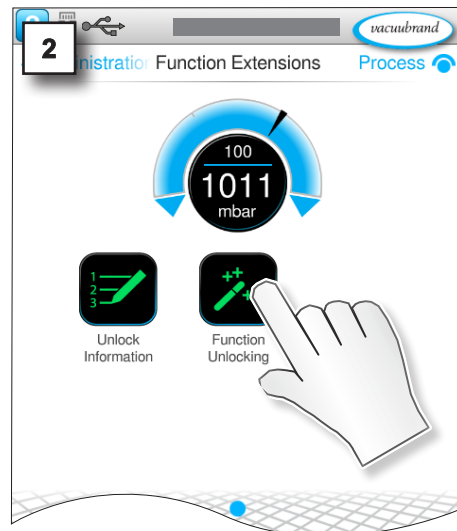

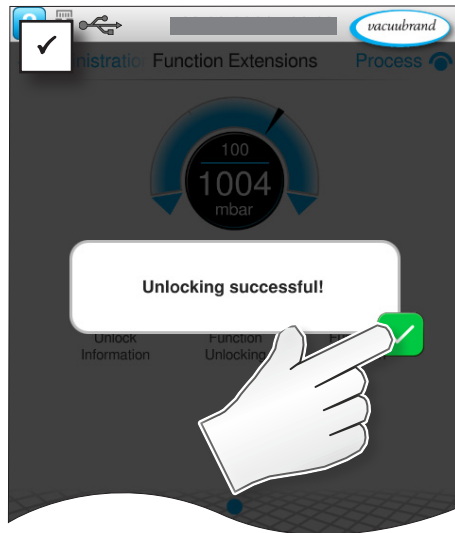

3.4 Deactivating function extensions

Example User Management – switching off function activation

→ Example
Main Menu \ Settings \
Administration \ Function
Extensions

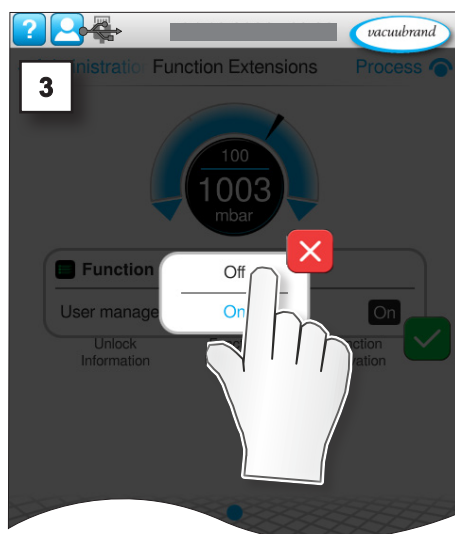
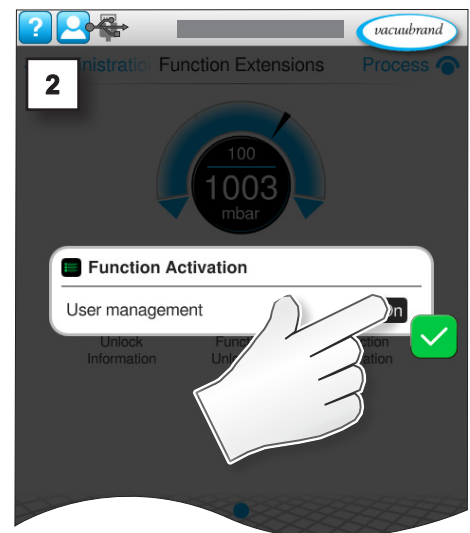

NOTE
Users and user groups are permanently deleted after confirming the message.
 ⇒ Export important user-specific settings before switching off the function extension → see Chapter: *4.5 Import/Export User Management*

→ Example
 Main Menu \ Settings \
 Administration \ Function
 Extensions

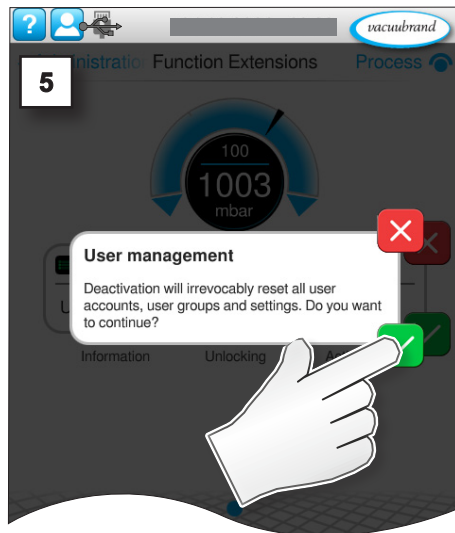
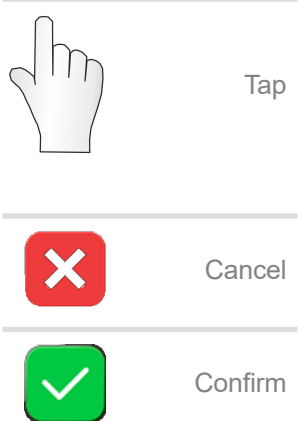

4 User Management

4.1 Creating an administrator password

→ Example
Creating a password
when activating User
Management



Tap



Cancel



Confirm

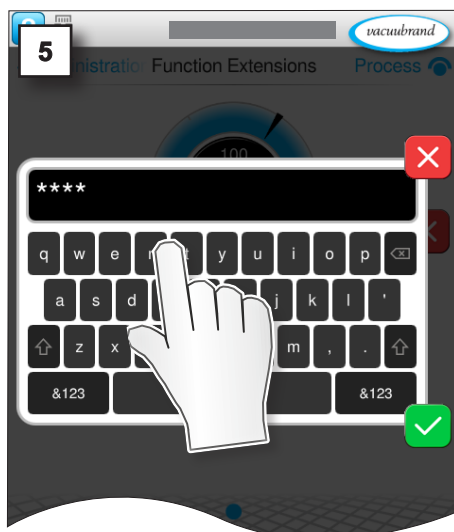
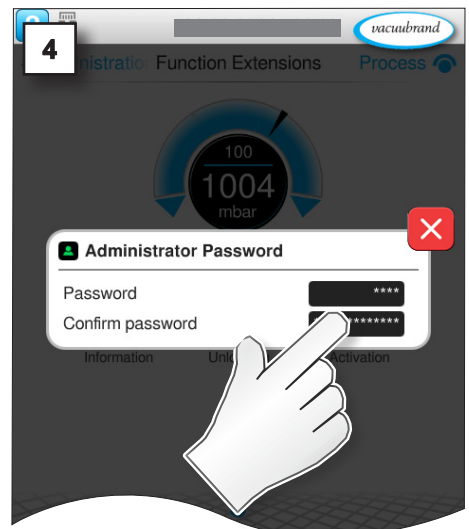
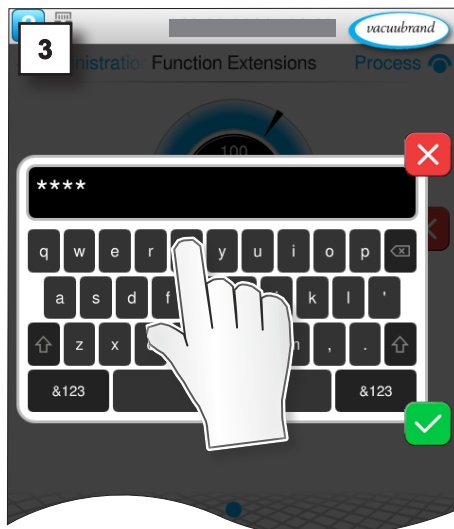
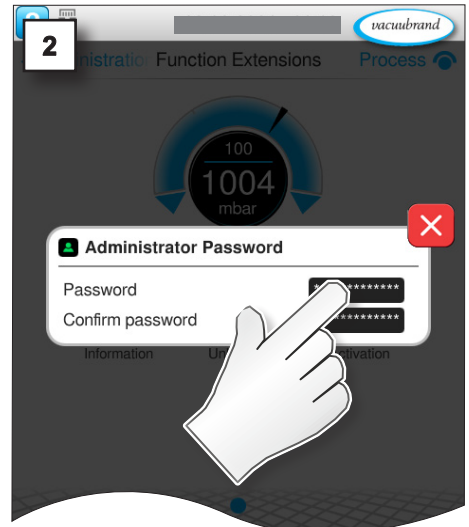
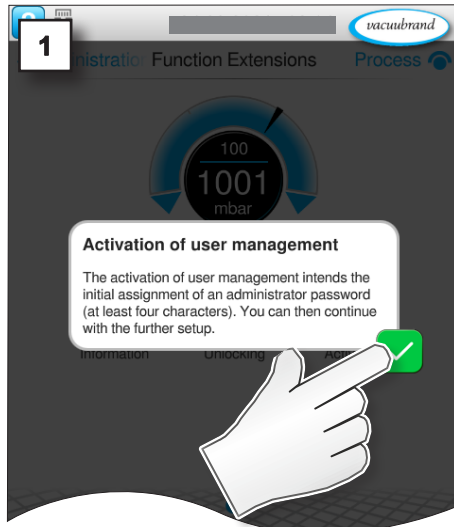

NOTE

- ⇒ Protect your controller from unauthorized access.
- ⇒ Store passwords and access data in a secure location.

4.2 User Accounts

4.2.1 Setting up and editing

Only the administrator or users who are assigned to the administrators user group can create new users.

Creating a new user

→ Example
Main Menu \ Settings \ Administration



Tap



Cancel



Confirm

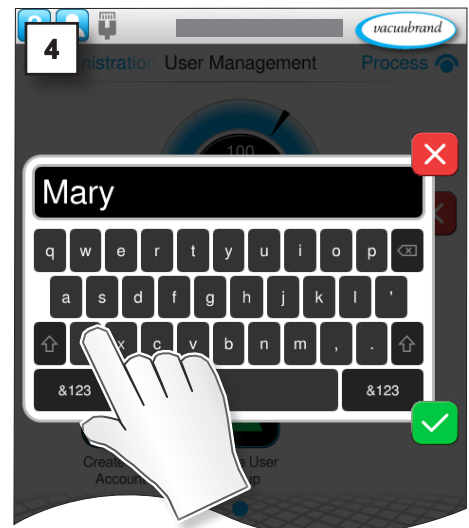
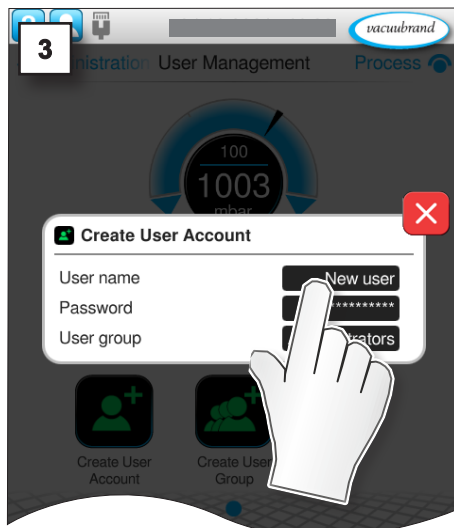
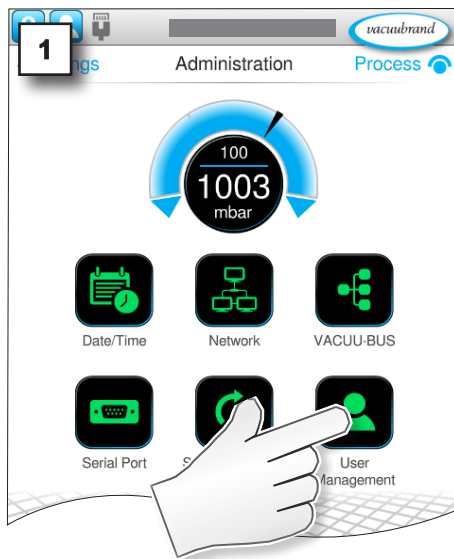

→ Example
Creating a new user



Tap



Cancel



Confirm

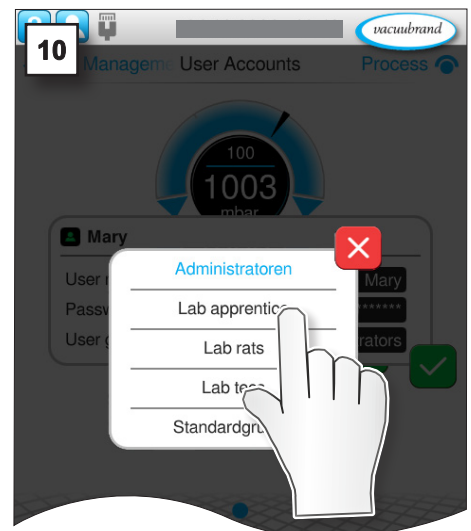
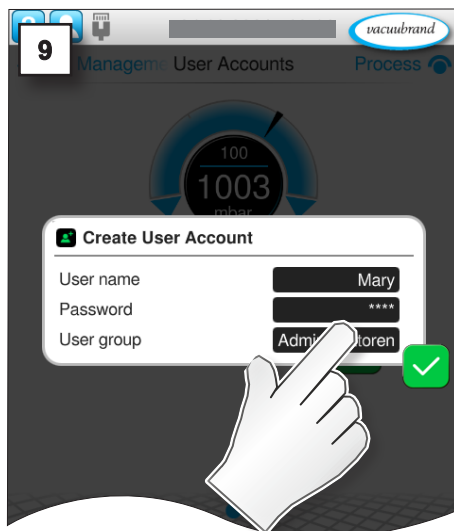
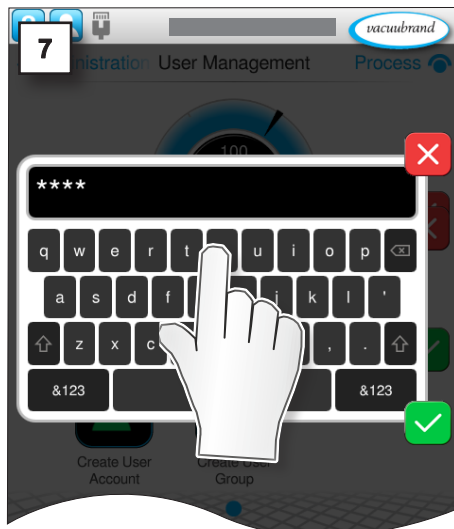
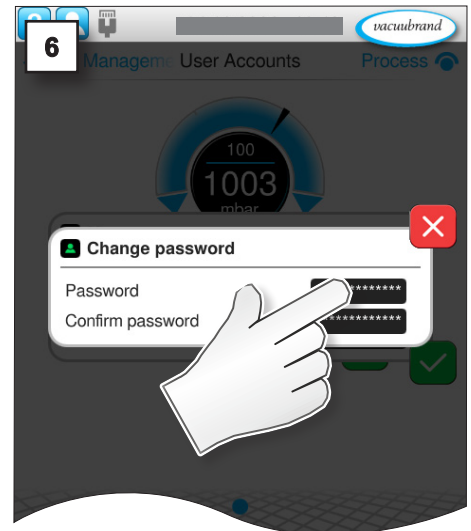
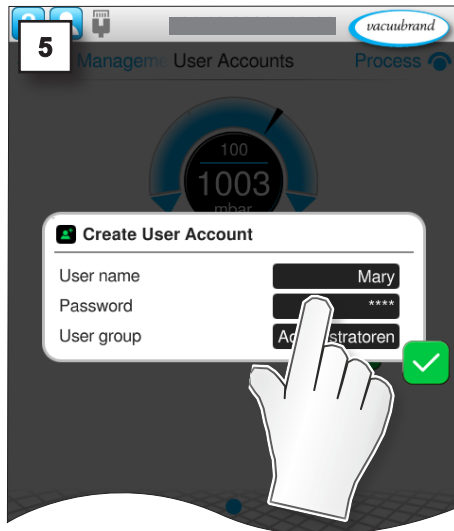

→ Example
New user



Tap

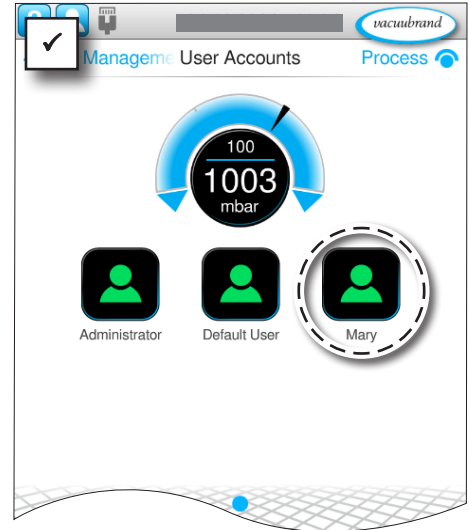

Editing users

→ Example
Main Menu \ Settings \
Administration \ User
Management \ User
Accounts



Press and hold

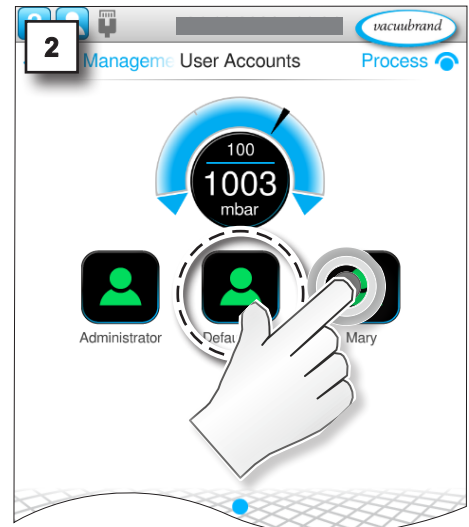
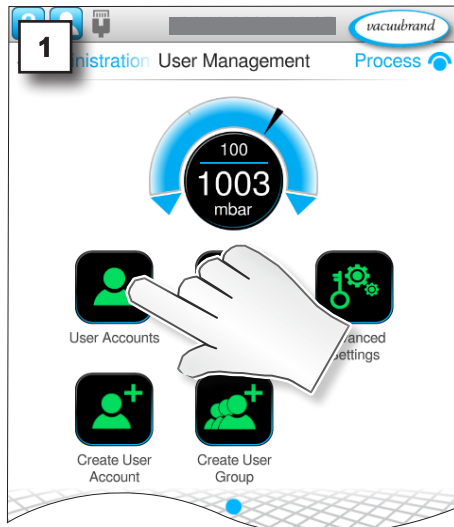

→ Example
Editing a user
Changing user data



Cancel



Confirm

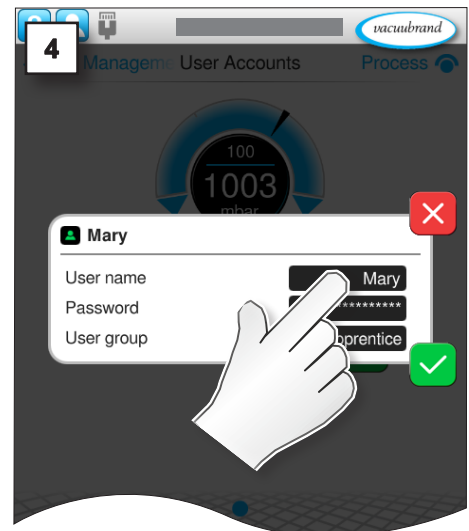
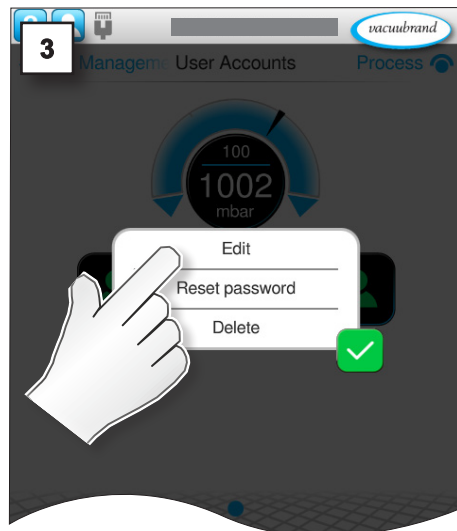

→ Example
Editing a user



Tap



Cancel



Confirm

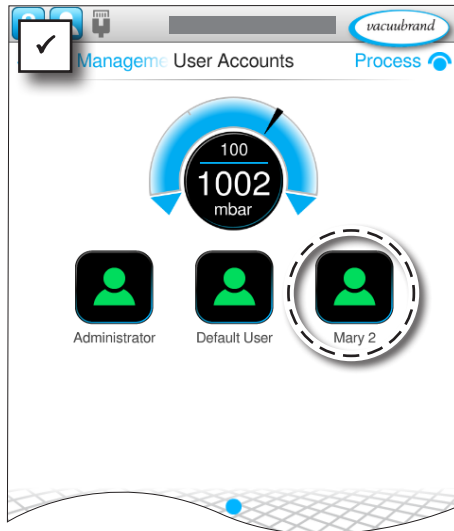
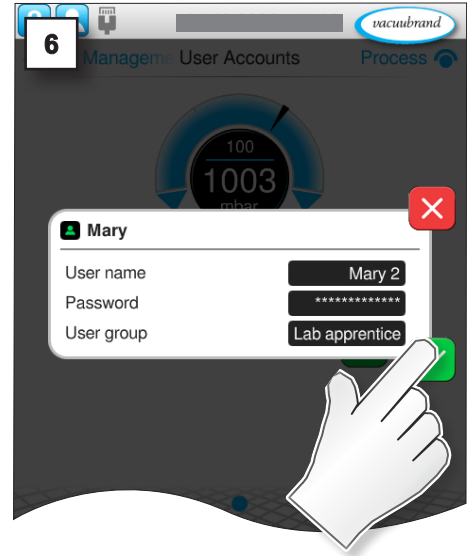
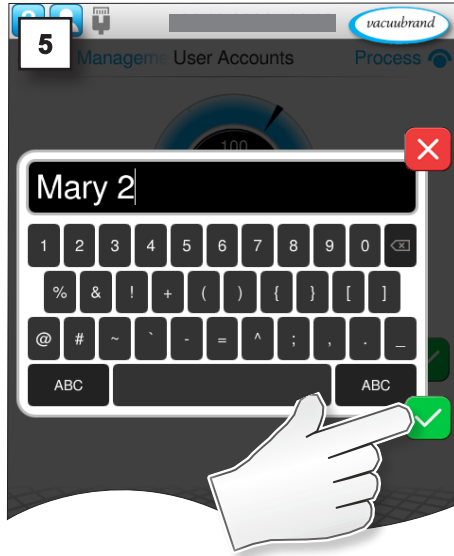





4.2.2 Removing users

NOTE
Users and the applications they created are permanently deleted after confirming the message.
 ⇒ Export important user-specific applications before deleting a user.

Deleting users

→ Example
 Main Menu \ Settings \
 Administration \ User
 Management \ User
 Accounts

-  Tap
-  Press and hold
-  Cancel
-  Confirm

→ Example
 Deleting a user

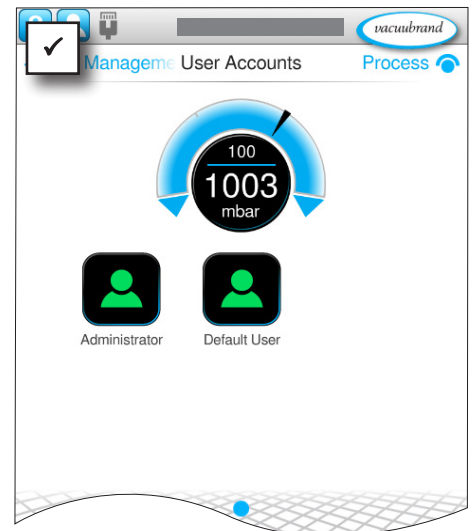
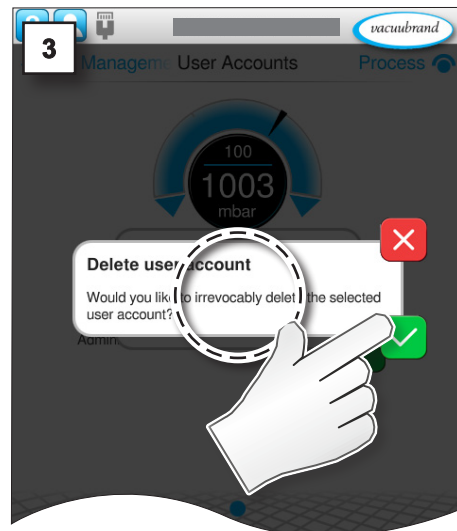
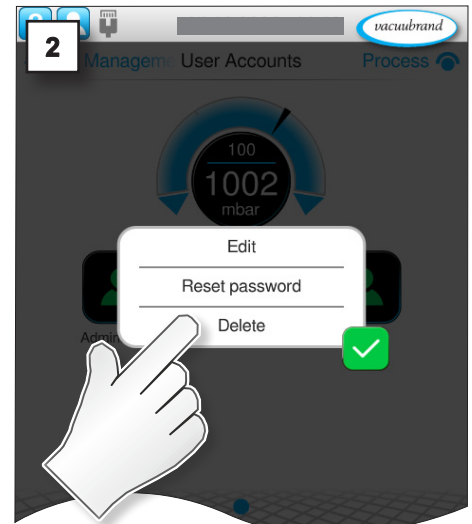
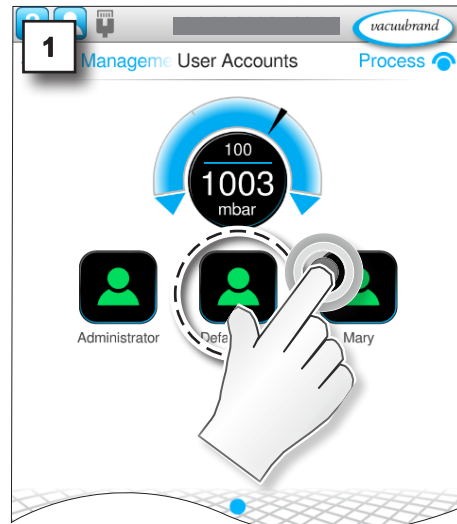

4.3 User groups

4.3.1 Setting up and editing

Creating a new user group

→ Example
Main Menu \ Settings \
Administration \ User
Management



Tap



Cancel



Confirm

→ Example
Entering a group name

→ Example
Configuring shared
applications

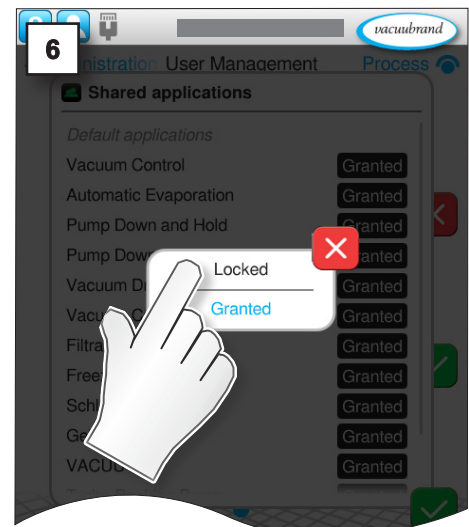
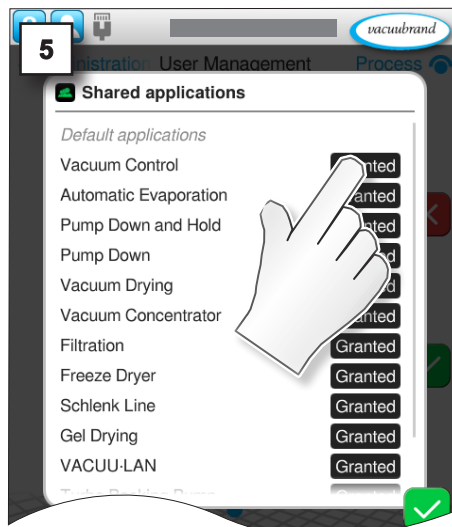
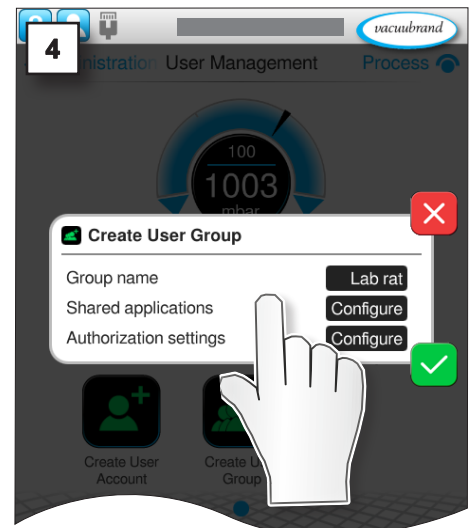
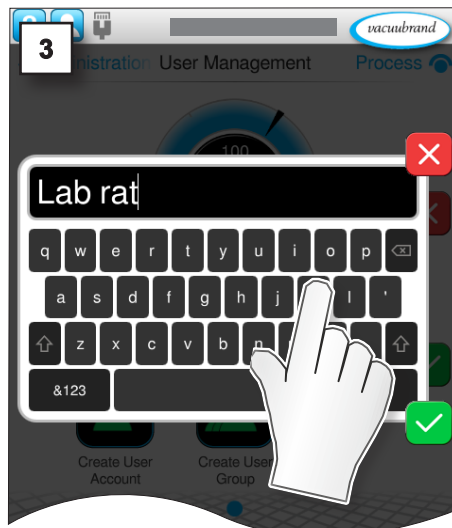
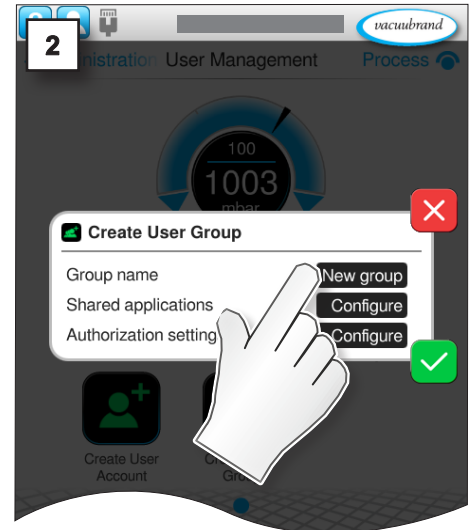

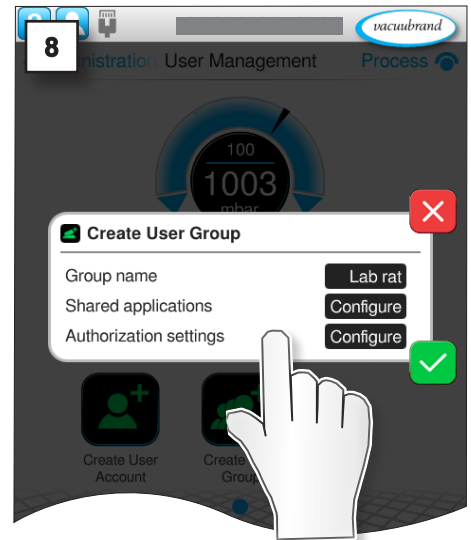
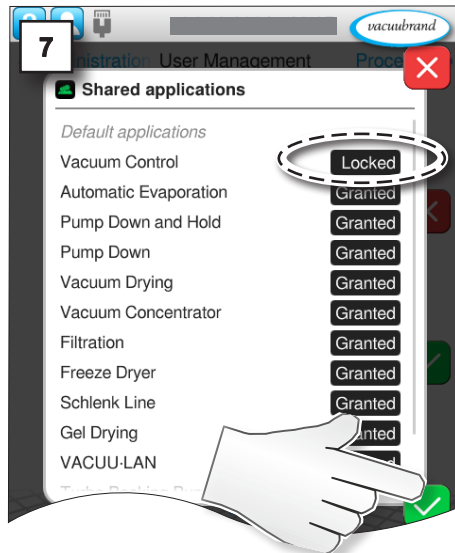

→ Example
Adjusting authorization
settings

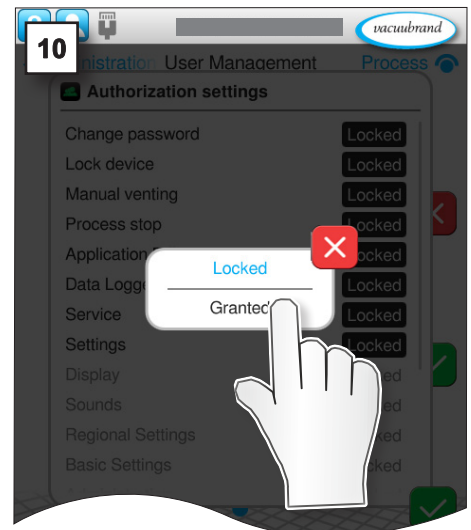
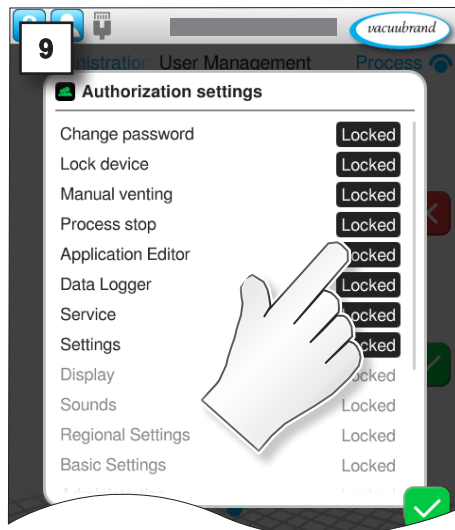

Tap



Cancel



Confirm

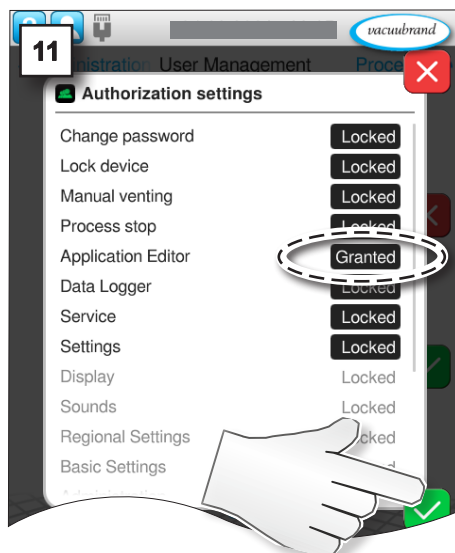

→ Example
Main Menu \ Settings \
Administration \ User
Management



Tap

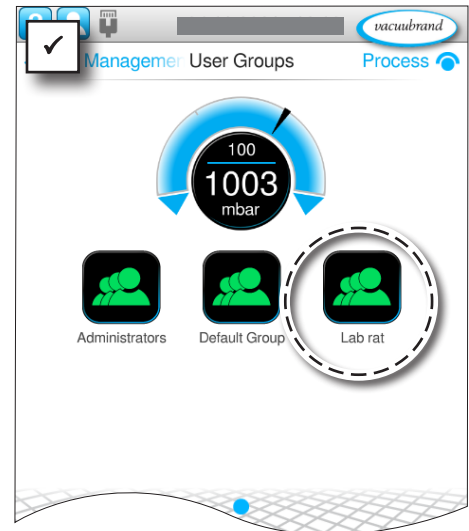

Meaning of the context menu

→ Example
Creating a new user
group

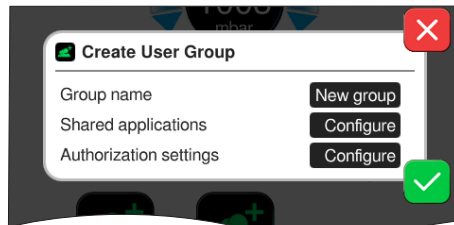

Context menu for creating a new user group with a suitable group name.

Shared applications

→ Example
Configuring shared
applications

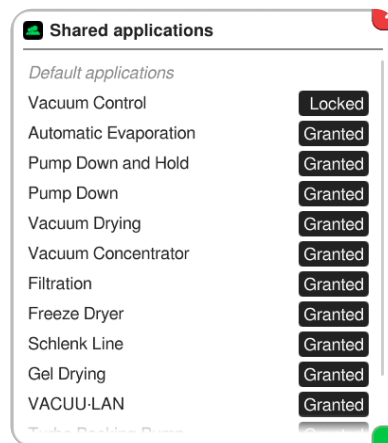

Authorization settings for using specific applications are made here.

- ▶ **Granted:** application unlocked for user group; granted applications are displayed in the application menu.
- ▶ **Locked:** application locked for user group and not listed in the application menu.
- ▶ The list contains all applications which are assigned to user accounts of the administrators group. This means that administrators can select from all default applications and the applications of other administrators when setting shared applications.

→ Example
Editing authorizations for a user group

Authorization settings

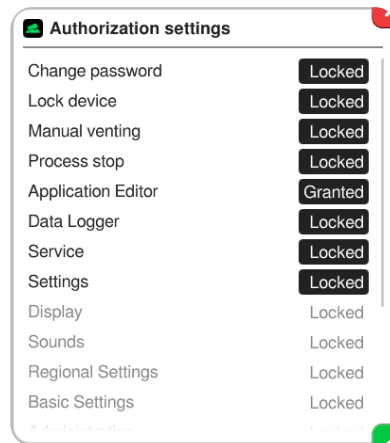

Menu for setting detailed authorizations of the user group.

▶ **Granted:** use of function unlocked for the user group.



▶ **Locked:** Use of function locked for the user group; button greyed-out.



4.3.2 Editing a user group + context menu

Opening the editing dialogue box

→ Example
Main Menu \ Settings \ Administration \ User Management \ User Groups

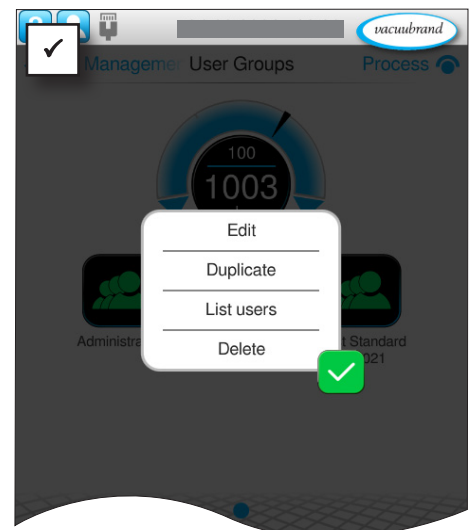
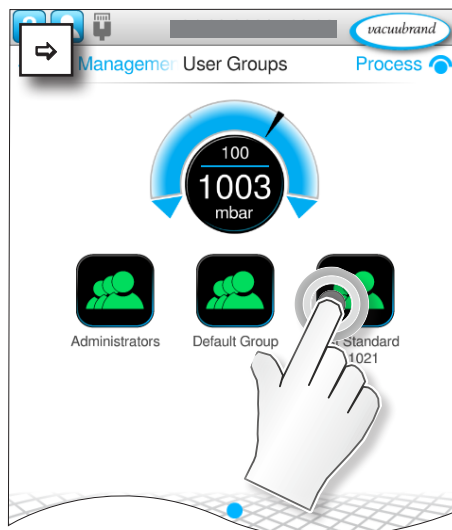
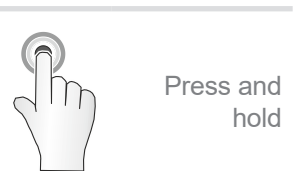

→ Example
Context menu for editing a user group

Meaning of the context menu

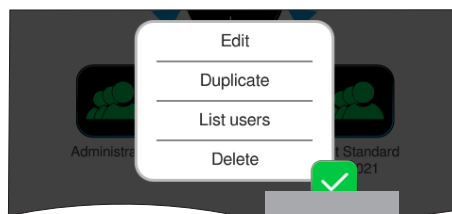
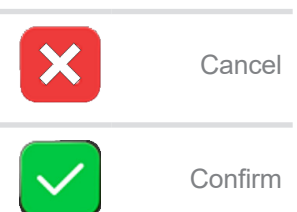

Context menu for editing existing user groups and displaying a list of assigned users.

→ Example
Context menu for editing
a user group

Edit

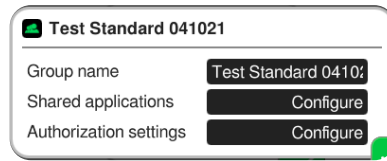

Adjustments to a user group can be made in the editing dialogue box at any time.

- ▶ change names,
- ▶ grant or lock access to applications,
- ▶ limit or expand user authorizations.

Duplicate



Create a copy of the selected user group.

NOTE

Only the user group is duplicated along with all its settings, not the assigned user accounts.

List users

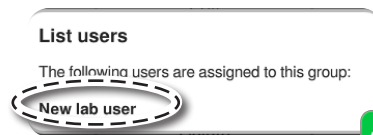

List users who are assigned to this user group.

Delete

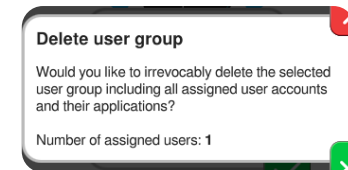

Delete a user group after confirming the security prompt.

NOTE

When user groups are deleted, the assigned user accounts are deleted; this means all user accounts and their applications are also deleted when a user group is deleted.

4.3.3 Advanced Settings

Opening Advanced Settings

→ Example
Main Menu \ Settings \
Administration \ User
Management

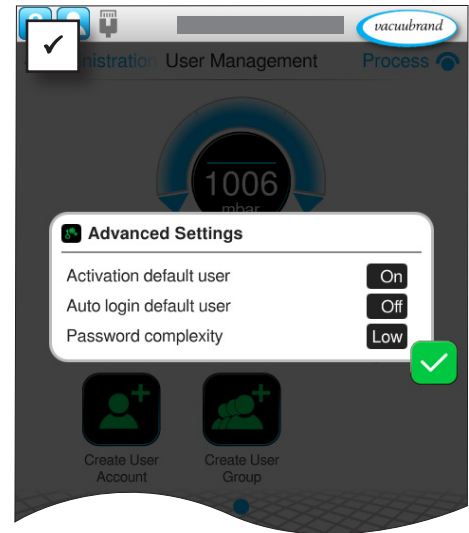
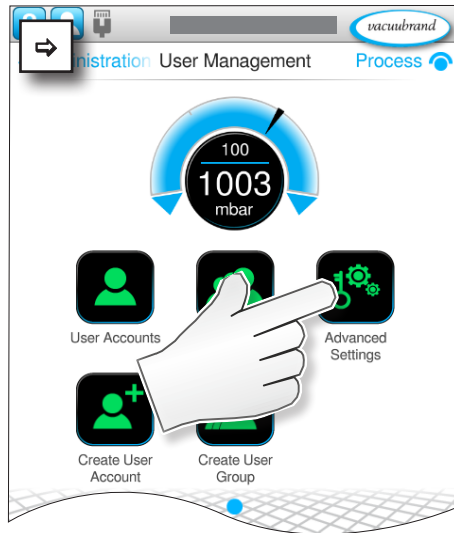
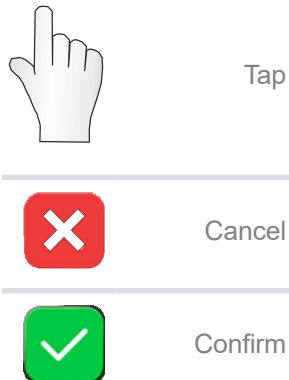

Meaning of the context menu

→ Example
Context menu for
Advanced Settings

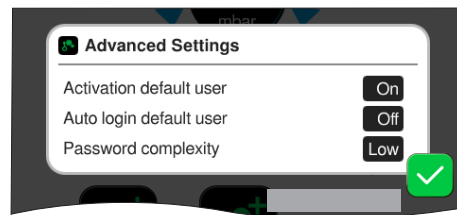

Menu for setting attributes for default users and user password requirements.

Activation default user

- Off
 - ▶ Default user deactivated.
 - ▶ Default user not in the login list.
- On
 - ▶ Default user activated.
 - ▶ Default user listed in the login list.

Auto login default user

- Off
 - ▶ Automatic login for default user deactivated.
 - ▶ Login of default user required after starting controller.
- On
 - ▶ Automatic login for default user activated.
 - ▶ Login of default user not required after starting controller.

Password complexity

- Low
 - ▶ At least 4 arbitrary characters.
- Medium
 - ▶ At least 8 characters, upper and lower case.
- High
 - ▶ At least 8 characters, upper and lower case, numbers and special characters.

4.4 User information

4.4.1 Switching users

From default user to administrator

→ Example
Process display default user

 Tap

 Cancel

 Confirm

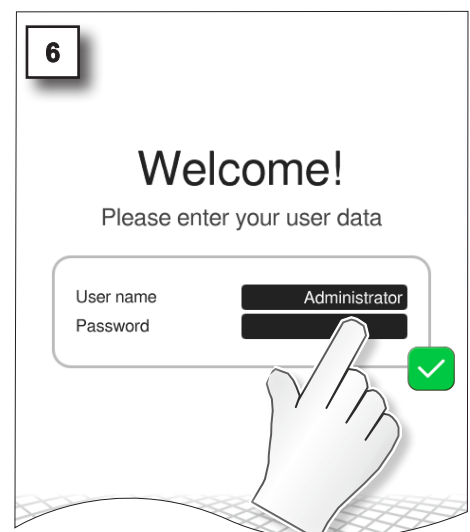
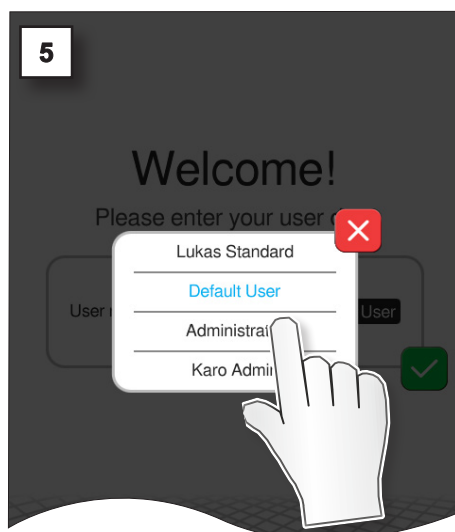
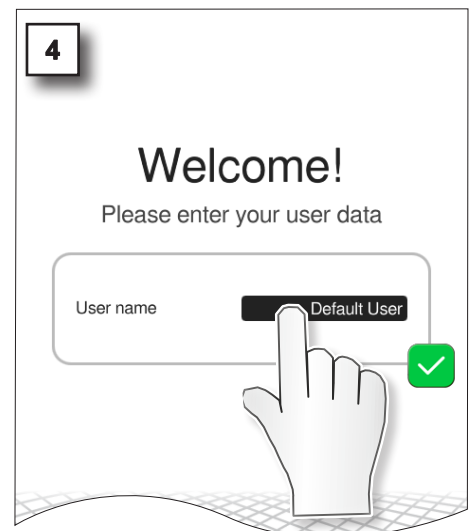
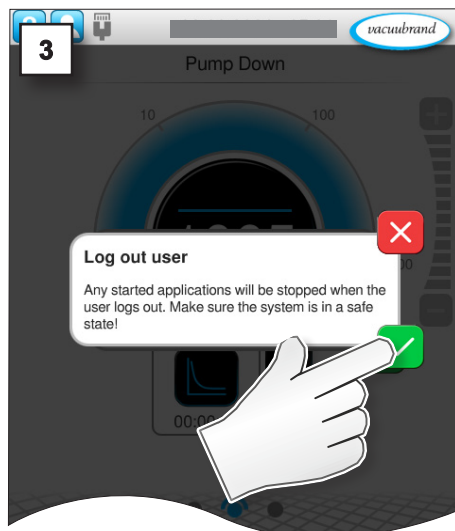
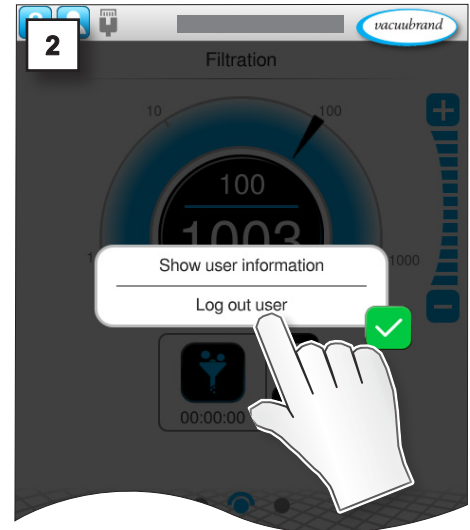
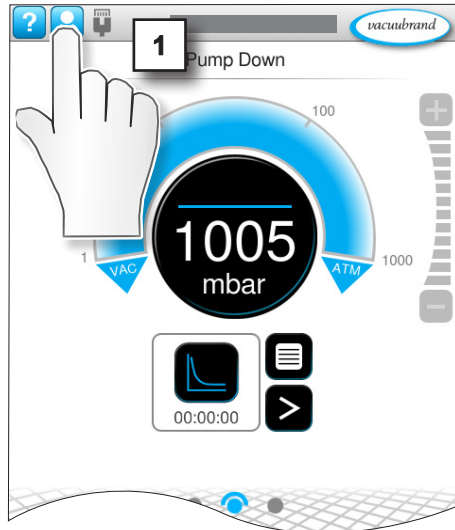



Tap



Cancel



Confirm

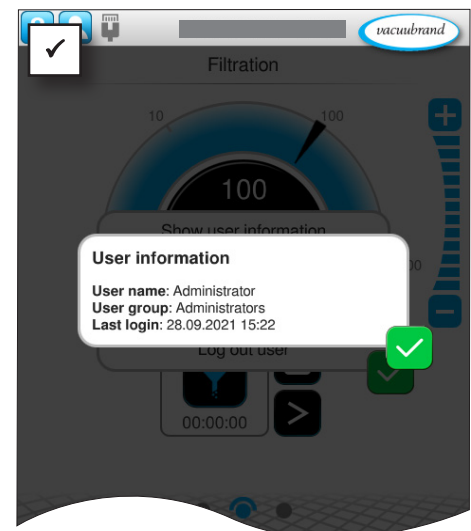
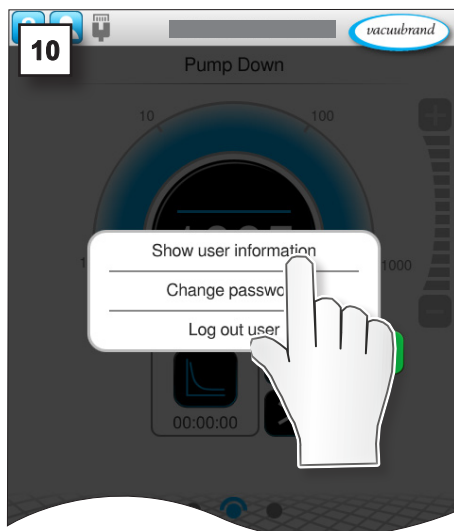
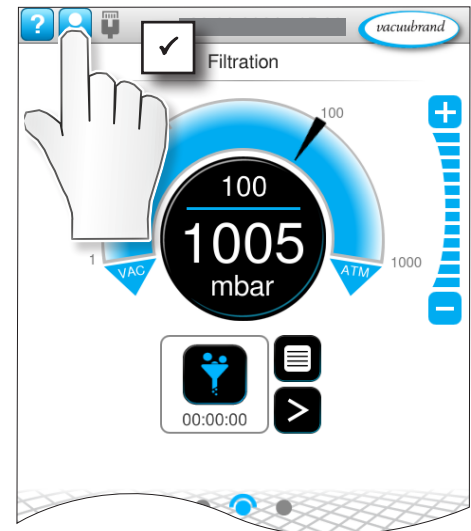
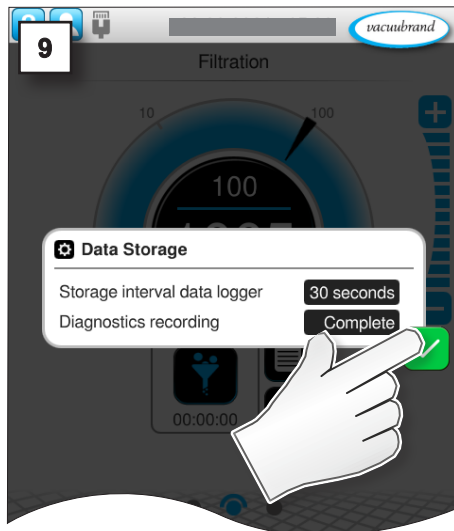
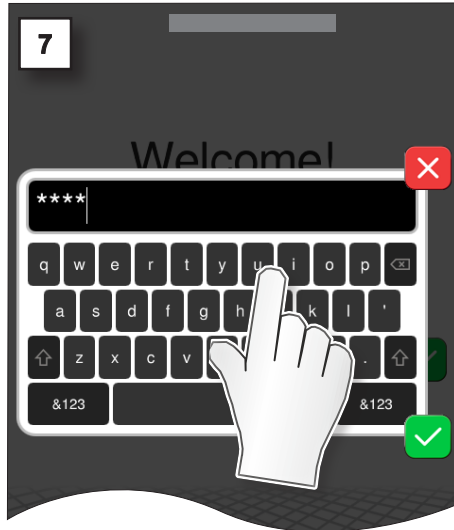

→ Example
User information



The default user has the only user account without a password. Therefore, no password can be entered on the login screen.

4.4.2 Locking and unlocking (display)

The menus in your controller may be displayed differently, depending on the user and the authorization settings. Users see only granted applications.

Display comparison

→ Example
Unlocked and locked
views

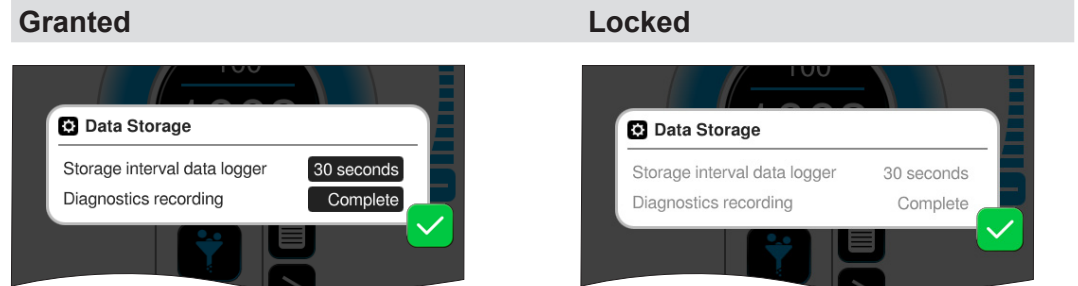

→ Example
Main menu: unlocked
and locked views

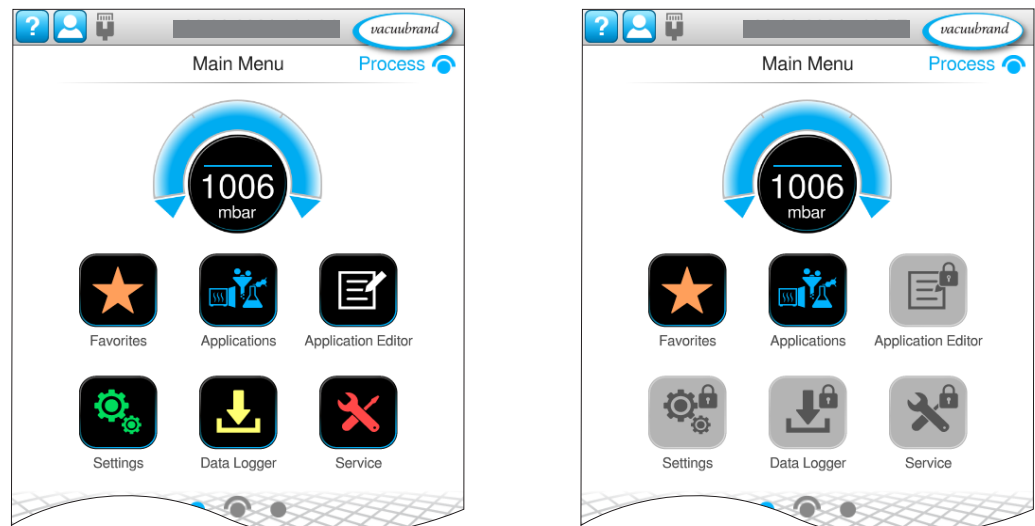

Tap



Cancel

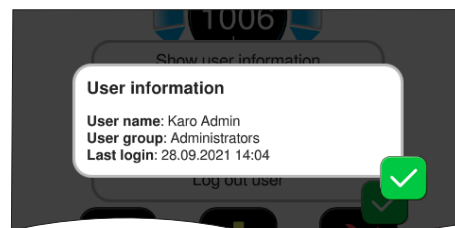

Confirm

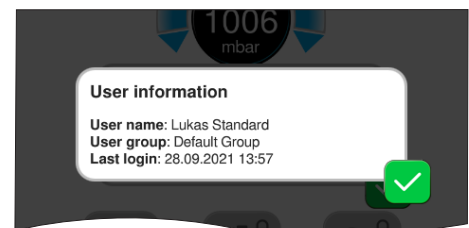
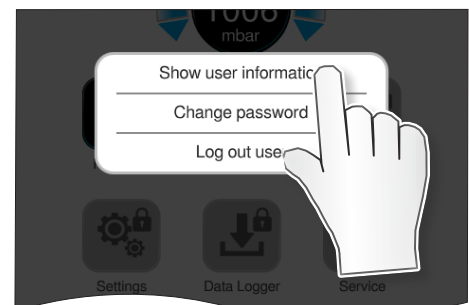

4.4.3 Other context menus explained

The following descriptions only apply in connection with the unlocked User Management function and are contingent on authorizations granted to the respective user.

Data storage

→ Example
Pop-up information on current data storage

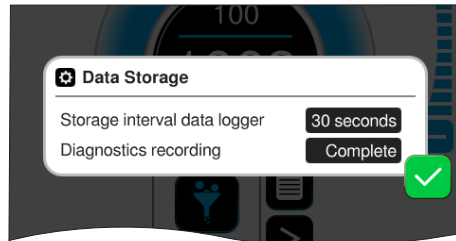

The data storage pop-up dialogue is shown at each restart and each time a new user logs in. Depending on the user's authorization, these settings can either be changed or not (content greyed out).

Storage interval data logger

- Logging off Data logging is switched off.
- Interval in seconds Data logging with defined time interval(s).

Recording diagnostics data

- Minimal Default setting for recording diagnostics data.
- Complete Records the following data:
 - ▶ User name of the user who started the process,
 - ▶ Diagnostics data (incl. time in each case),
 - ▶ User login/logout,
 - ▶ Locking/unlocking of the controller by a user,
 - ▶ Reset the administrator password,
 - ▶ Initial set-up of User Management,
 - ▶ Deactivation of User Management.

Example – recorded process data

→ Example
Display of recorded process data

Abpumpen	Administrator	Step	VS-C 1
Timestamp	DateTime		
1632834051	Tue Sep 28 15	1	1000
1632834052	Tue Sep 28 15	1	1000
1632834053	Tue Sep 28 15	1	1000
1632834054	Tue Sep 28 15	1	1000
1632834055	Tue Sep 28 15	1	1000
1632834056	Tue Sep 28 15	1	1002
1632834057	Tue Sep 28 15	1	1008

User Options

→ Example
User Options context menu

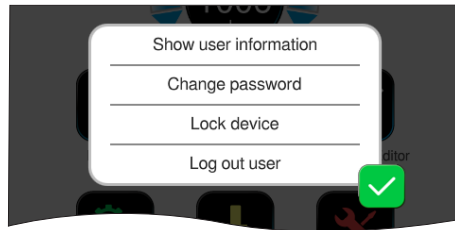
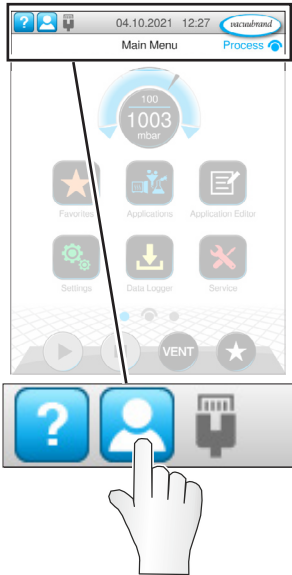

Context menu of User Options.
The selection of functions depends on the authorization of the respective user.

Show user information

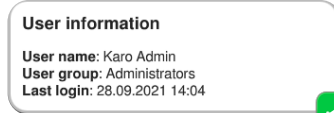

Displays information on the user currently logged in.

Change password

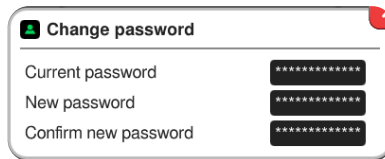

Context menu for changing the user password.

Lock device



Switch on screen lock to prevent unauthorized access to the controller. If an application has been started, it can continue to run in the background.
To unlock, tap the display and enter the user password. The user is displayed on the lock screen.

Log out user

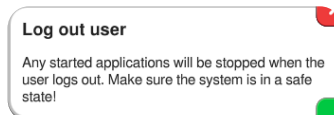

Confirm the security prompt to open the login screen, and change the user. If an application has been started, logging out will stop it.

4.5 Import/Export User Management

IMPORTANT!

For import and export, the option *User Management + Applications* is only visible when User Management is unlocked and activated.

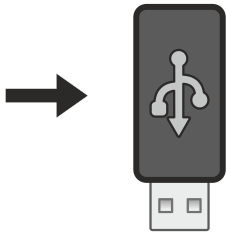

4.5.1 Export User Management + Applications

You can use the export function to transfer or save data, e.g. created users or user groups, to other controllers via a USB flash drive.

Exporting created users, user groups and applications

→ Example
Main Menu \ Settings \ Administration



Tap



Cancel



Confirm

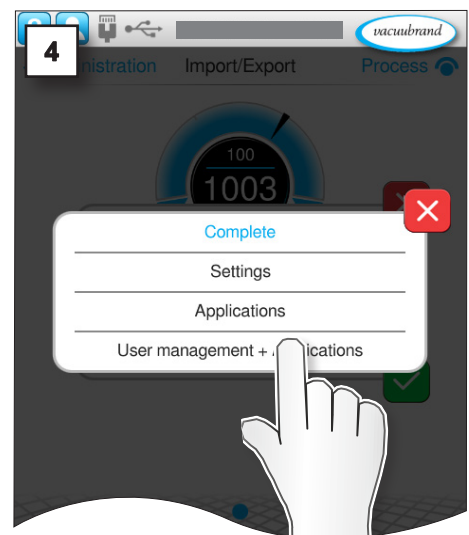
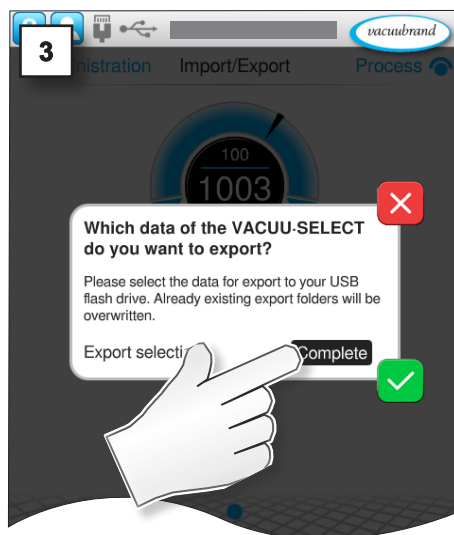
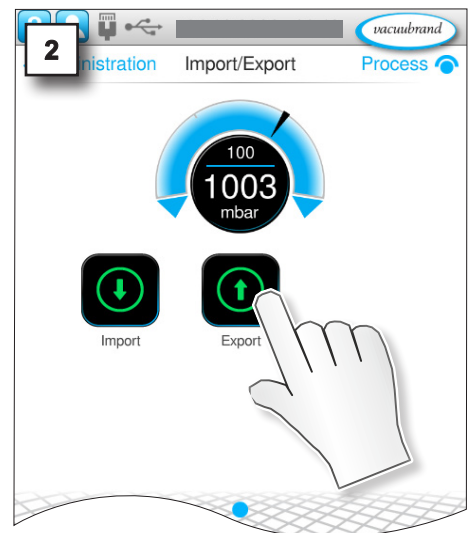
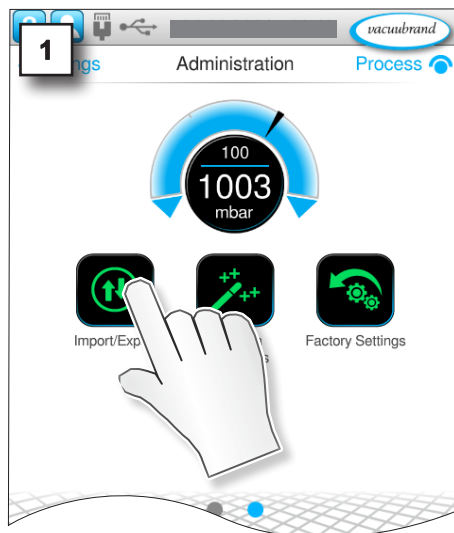

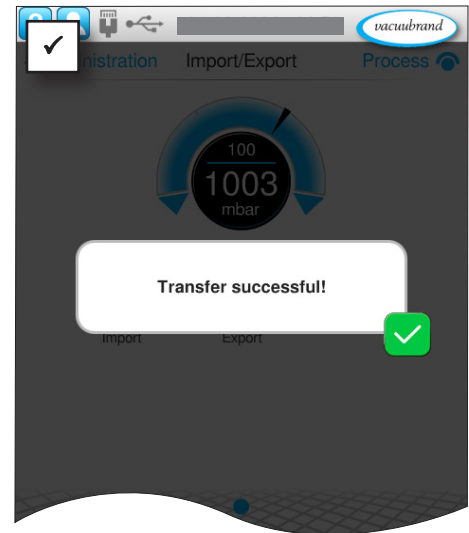
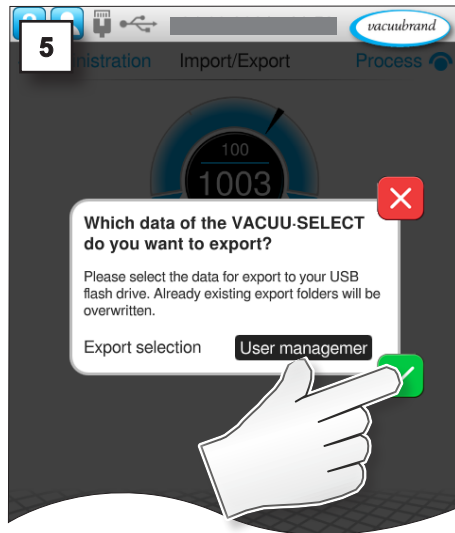

4.5.2 Import User Management + Applications

You can use the import function to import data, e.g. created or saved users or user groups, to your controller via a USB flash drive.

Importing created users, user groups and applications

→ Example
Main Menu \ Settings \ Administration



Tap



Cancel



Confirm

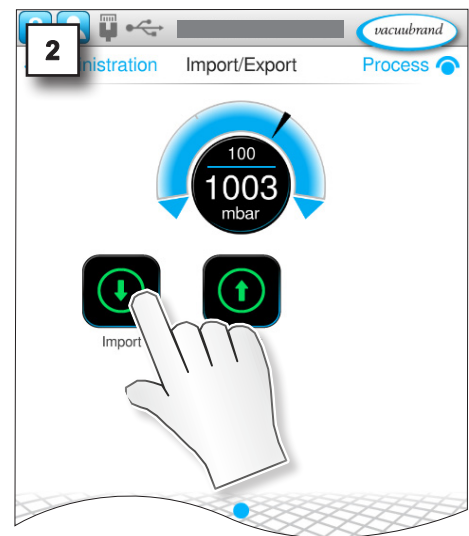
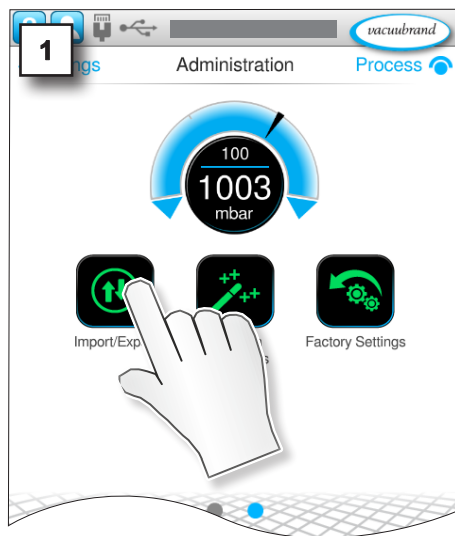

NOTE

When importing data from User Management, existing custom applications and created users are deleted from the device.

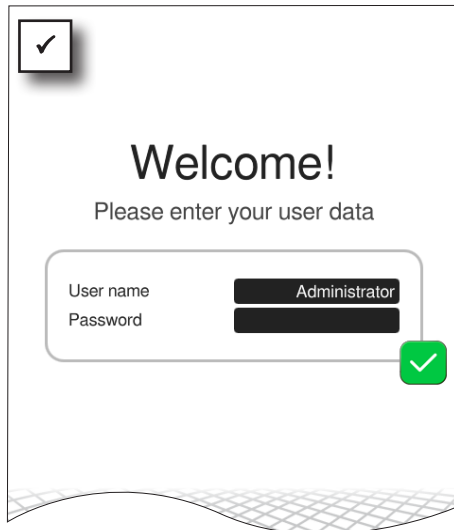
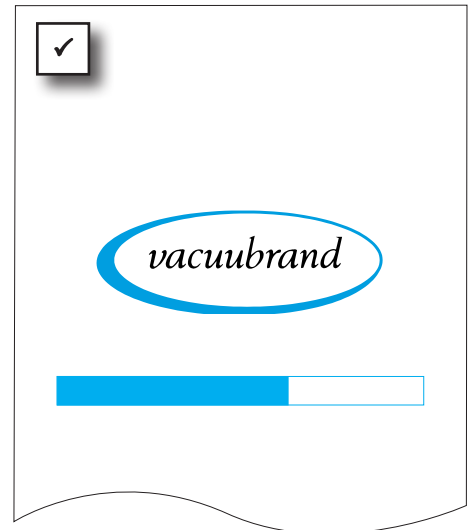
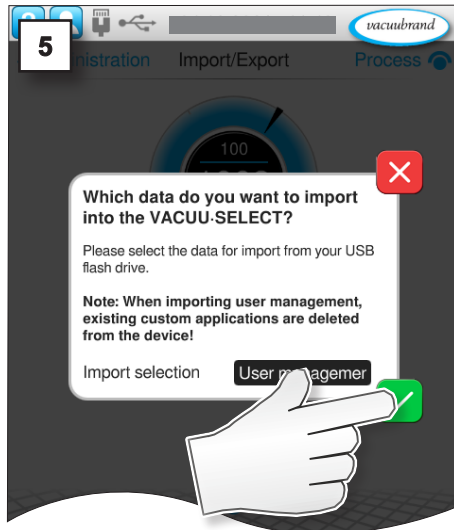
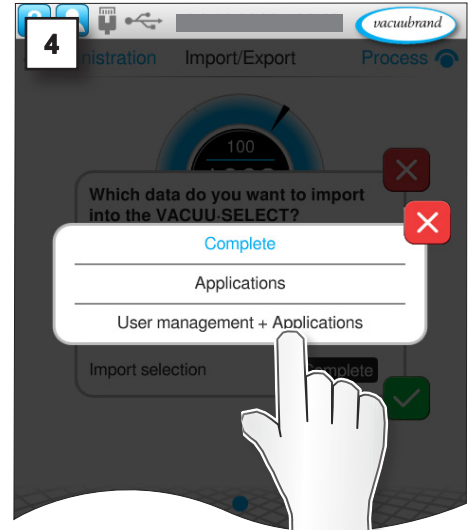
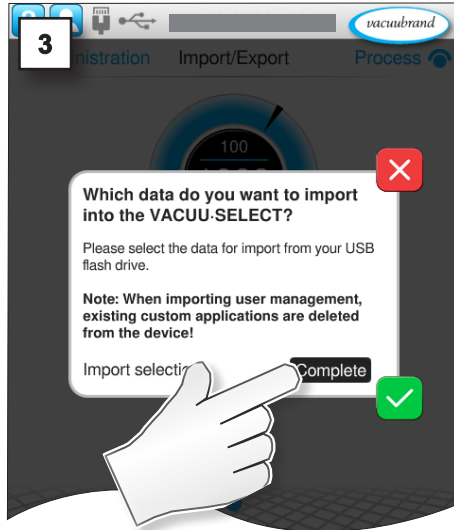

4.6 Login/logout

IMPORTANT!

Only one user can be logged in to the controller at any given time. Simultaneous use of the controller by multiple users is not possible.

4.6.1 Login at start up

A login window appears when the controller is started.

Exception: When the default user and auto login are active, the user is automatically logged into this account; → see Chapter: **4.3.3 Advanced Settings**.

4.6.2 Auto start function

Requirement: Auto start is activated in the default settings of the controller; → refer to the user manual of your controller for more information.

After the controller is restarted, this is only activated if the default user is activated, auto login is activated and the default user was the last to log in and had started an application.

4.7 Password reset

4.7.1 User password

Resetting the user password

Assign new user password

1. Log in as administrator.

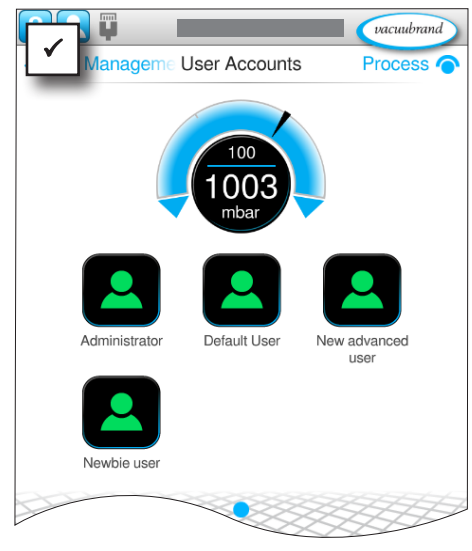
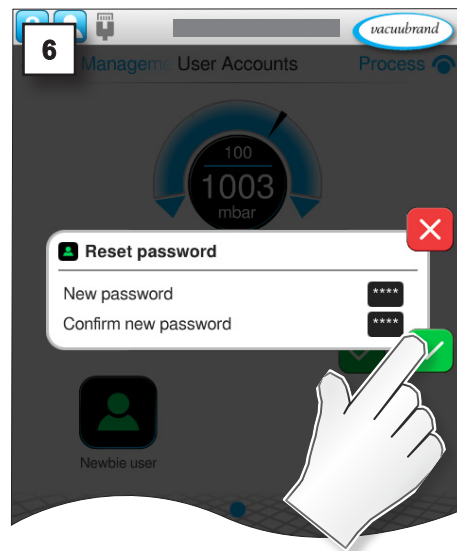
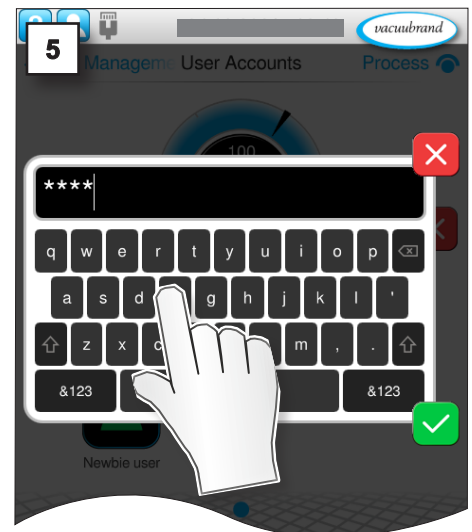
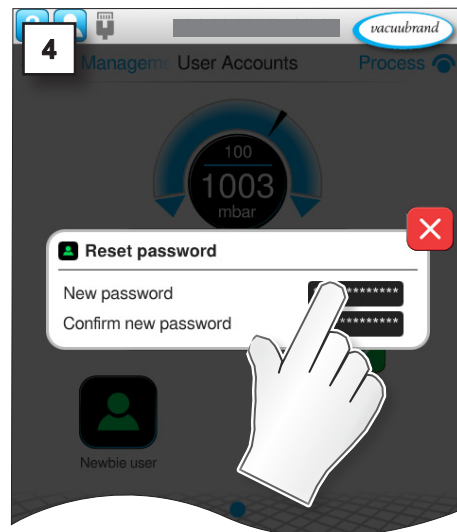
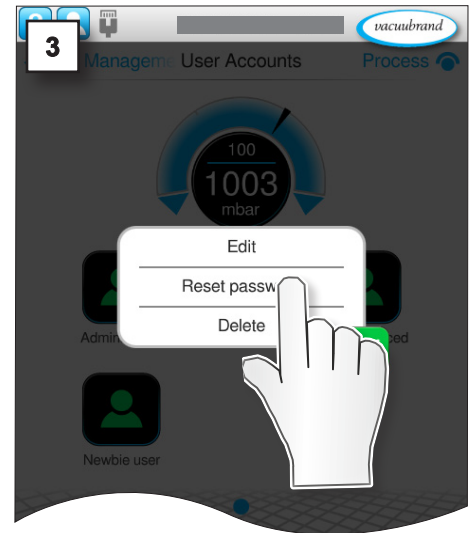
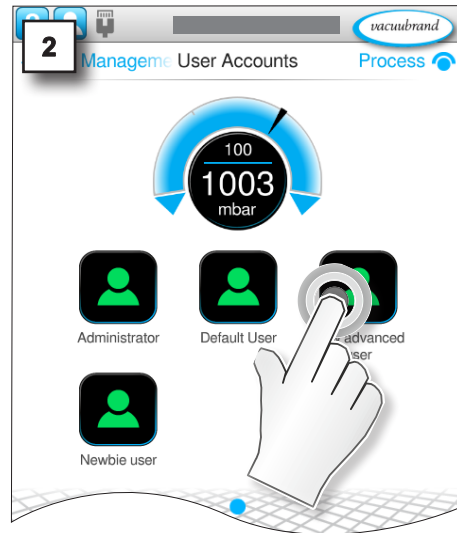

4.7.2 Administrator password

If your password is no longer available, you can assign a new password as an administrator in the login screen.

Resetting the administrator password

Assign new administrator password

1. Turn the controller off and on again.
- 2.

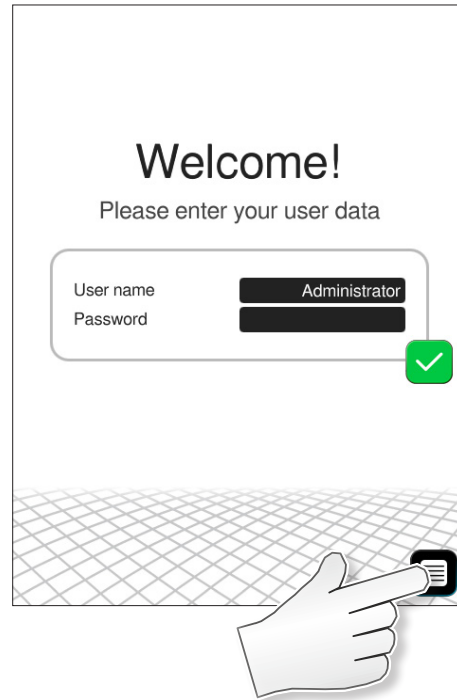

3. Have the license code or license file for your controller ready and proceed as follows: **3.3.1 Via license code** or **3.3.2 Via USB flash drive**

5 SYNCHRO

5.1 User interface

Special feature

Two pressure curves are displayed in the process screen, pressure curves **A** and **B**, corresponding to labeling of valves A and B. This enables control of two different applications. The processes will run essentially independently of each other. Operating elements and settings are always active for the selected process.

User interface

VACUU-SELECT® with two process screens

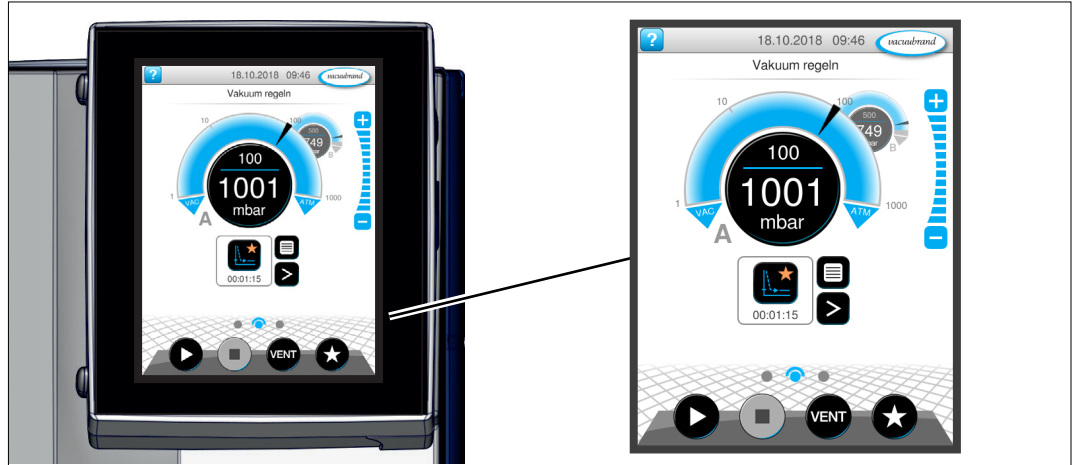

Process screen

Pressure display for two electronically controlled processes A and B

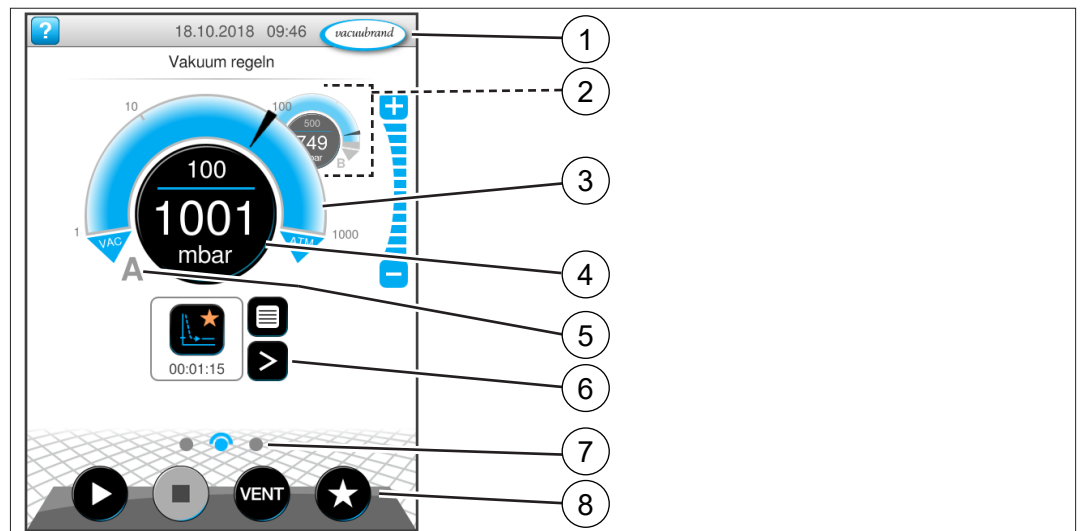

- | | |
|---|---|
| 1 | Status bar |
| 2 | Process screen B – in the background |
| 3 | Analogue pressure display – pressure curve |
| 4 | Digital pressure display – pressure value (target value, actual value, pressure unit) |
| 5 | Process screen A – in the foreground |
| 6 | Process screen with context features |
| 7 | Screen navigation |
| 8 | Operating elements for control |

Assignment of the process screen

→ Example
Assignment of process
screen and valves
(view of details)

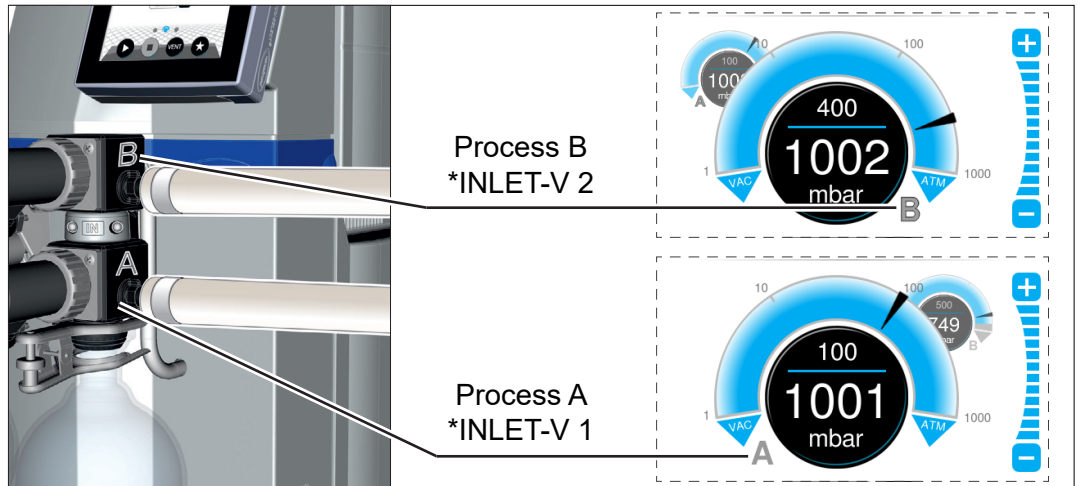

To avoid operating errors or simultaneous operation of two processes, the process screen can be switched; see:
 ⇒ **Switch the process screen from A to B on page 43 and**
 ⇒ **Switch the process screen from B to A on page 43.**

Alignment *VACUU·BUS addresses

VACUU·BUS addresses
for processes A and B

Certain VACUU·BUS components like vacuum sensors, venting valves, and in-line solenoid valves need to be assigned exclusively to one of the two processes. The alignment takes place automatically according to the assigned address:

Component	VACUU·BUS name	Address no.	
		Process A	Process B
In-line solenoid valve	INLET-V	1, 3	2, 4
Venting valve	VENT-V	1, 3	2, 4
Vacuum sensor, capacitive	VS-C	1, 3	2, 4
Pirani vacuum sensor	VS-P	1, 3	2, 4
Reference sensor	VS-REF	1, 3	2, 4



In the event of an error, only the process assigned to that component is stopped, e.g., error on VS-C 1 vacuum sensor → Process A stops → Error message process screen A.

Components not supported: I/O REMOTE, I/O VACUUM (OUT), I/O SPEED (OUT), all VARIO pumps and valve type END-V.

All other VACUU·BUS components are global and are used by both processes, e.g., WATER-V coolant valve.

Switch the process screen from A to B

→ Example
Switch from process A to process B

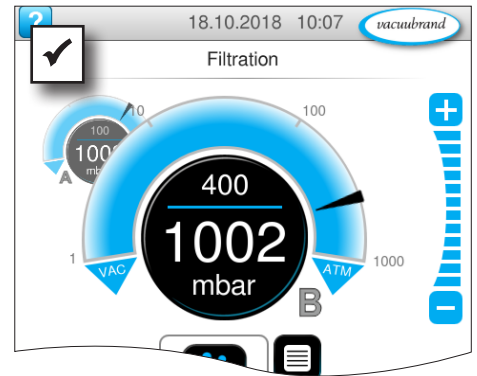
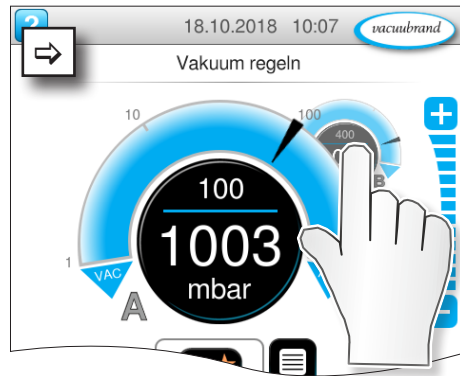

- ⇒ Tap on rear pressure curve.
 - Process B in front.
 - Operation process B enabled.
 - Operation process A locked.

Switch the process screen from B to A

→ Example
Switch from process B to process A

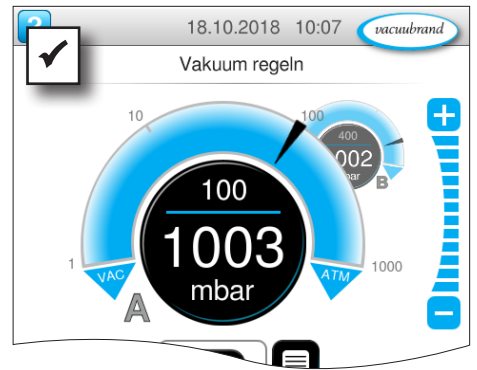
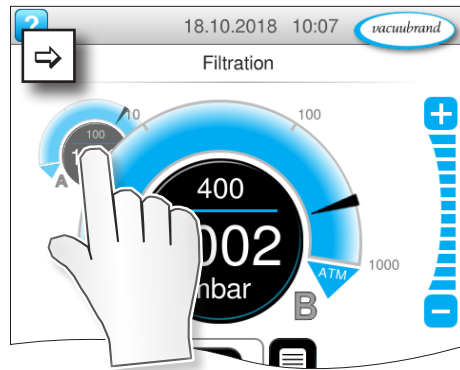

- ⇒ Tap on rear pressure curve.
 - Process A in front.
 - Operation process A enabled.
 - Operation process B locked.

5.2 Error indication

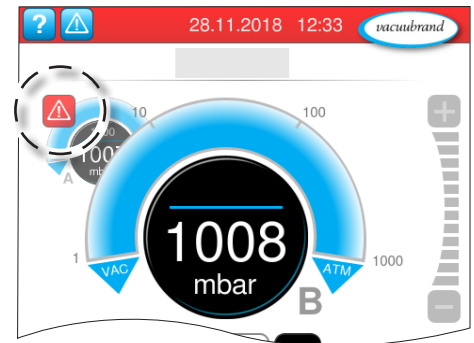
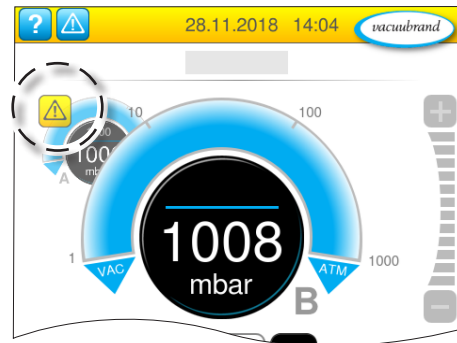
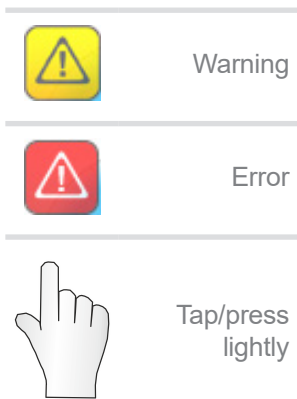

Warnings and / or errors are indicated by a flashing pressure curve. If the flashing pressure curve is pressed, the process with fault can be called up. The process without fault continues operation. If both processes are affected by the fault, both processes stop.

For errors the same rule applies, as for a controller with only one pressure curve: remedy fault and acknowledge error message.

6 Troubleshooting

6.1 Function Extensions

Problem	▶ Possible cause	✓ Solution	Personnel
No license file found	<ul style="list-style-type: none"> ▶ No USB flash drive inserted. ▶ USB flash drive inserted without a valid license. 	<ul style="list-style-type: none"> ✓ Insert a USB flash drive with valid license. <p>IMPORTANT! License files must be saved to the root directory of the USB flash drive and not to a sub-directory.</p>	Operator, specialist

6.2 User Management

Problem	▶ Possible cause	✓ Solution	Personnel
Login failed	<ul style="list-style-type: none"> ▶ Password not valid for selected user. ▶ No password entered or password entered incorrectly. 	<ul style="list-style-type: none"> ✓ Choose an appropriate user. ✓ Enter the correct password. ✓ Turn off the controller, restart it and log in. 	Administrator, default user
Invalid or incorrect password	<ul style="list-style-type: none"> ▶ Wrong user password entered. ▶ Password changed. ▶ Password no longer available. 	<ul style="list-style-type: none"> ✓ Enter the correct user password. ✓ On the login screen, reset the password with the aid of a valid license file. ✓ Assign a new password and store it in a secure location. 	Default user, administrator
Functions in the main menu locked	<ul style="list-style-type: none"> ▶ User authorizations have not been granted for the logged in user. 	<ul style="list-style-type: none"> ✓ Use authorized functions. ✓ Consult with the administrator about the functions your users need and have authorization granted for these functions. 	Default user, administrator
Controller locked	<ul style="list-style-type: none"> ▶ Controller was locked by user with the authorization <i>Lock Device</i>. Corresponding user is listed on the lock screen. 	<ul style="list-style-type: none"> ✓ Tap on the controller display and enter the password. ✓ Turn off the controller, restart it and log in again. 	Default user, administrator

Problem	Possible cause	Solution	Personnel
User Management menu not shown	<ul style="list-style-type: none"> ▶ User Management deactivated. ▶ Function extensions not unlocked. ▶ No valid license found. 	<ul style="list-style-type: none"> ✓ Activate menu under Main Menu \ Settings \ Administration \ Function Extensions \ Function Activation (= ON); password entry required. ✓ Unlock function extensions. ✓ Enter the matching license code for your controller or transfer the license file via USB flash drive. 	Administrator
Created users or user groups missing	<ul style="list-style-type: none"> ▶ No users or user groups created. ▶ User Management was deactivated in the Function Extensions menu, without exporting User Management beforehand. ▶ Controller was reset to its default settings. 	<ul style="list-style-type: none"> ✓ New users and user groups can be created and edited in User Management. ✓ Export and save created users and user groups to a USB flash drive before you deactivate User Management or reset the controller to its default settings. 	Administrator
Button or input field grayed out	<ul style="list-style-type: none"> ▶ User input locked. 	<ul style="list-style-type: none"> ✓ If use of a function is required, have the administrator grant authorization to use the function. ✓ Change users. 	Default user, administrator

6.3 SYNCHRO

Problem	Possible cause	Solution	Personnel
Missing components	<ul style="list-style-type: none"> ▶ Erroneous component configuration. ▶ Missing VACUU·BUS components. 	<ul style="list-style-type: none"> ✓ Check component configuration. ✓ Connect missing VACUU·BUS components and run component detection. 	Operator, specialist

7 Appendix

Ordering information

Ordering information

Product	Order No.
User Management	20700900
SYNCHRO	20700910

Supply sources

Supply sources

Purchase original accessories and original replacement parts from a branch location of **VACUUBRAND GMBH + CO KG** or from your local specialist shop.



Information on the complete range of products can be found in the current [product catalogue](#).

For orders, questions about vacuum control or optimal accessories, please contact your local specialist shop or the **VACUUBRAND** [sales office](#).

8 Index

A		T	
Acquiring a license	10	Transferring the file	
Action instructions	7	via USB flash drive	15
Action step	7	U	
Activating function extensions	12	Unlocked and locked views	32
Adjusting authorization settings	25	Unlocking with license code	10
Assigning a new administrator password	40	User Management function extension	10
Assigning a new user password	39		
B			
Buttons in Administration menu	8		
Buttons in Function Extensions menu	8		
Buttons in User Management menu	8		
C			
Changing user data	21		
Configuring shared applications	24, 26		
Context menu for Advanced Settings	29		
Context menu for editing a user group	27, 28		
Context menu for User Options	34		
Creating a new user	20		
Creating a new user group	26		
Creating an User Management password	18		
D			
Deleting users	23		
Display of operating steps	7		
Display of recorded process data	33		
E			
Editing authorizations for a user group	27		
Editing user groups	27		
Editing users	21, 22		
Entering a license code	14		
Export User Management	35		
F			
Function extensions	12		
G			
Gestures	6		
Graphical operating steps	7		
I			
Import User Management	36		
Information on data storage	33		
N			
New symbol in the status bar	7		
New user	21		
O			
Opening function extensions	12		
Operating steps	7		
Ordering information	47		
P			
Product description of function extensions	10		
R			
Requesting a license file	13		
Requirements	10		
Resetting the administrator password	40		
Responsibility matrix	9		
S			
Supply sources	47		
Supported software version	10		
Switch the process screen from A to B	43		
Switch the process screen from B to A	43		

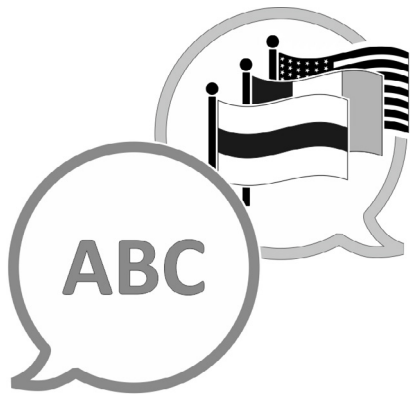
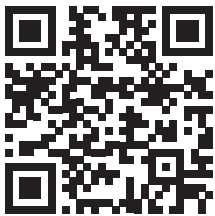

[VACUUBRAND > Support > Manuals](#)

Manufacturer:

VACUUBRAND GMBH + CO KG
Alfred-Zippe-Str. 4
97877 Wertheim
GERMANY

Phone:

Head office +49 9342 808-0
Sales +49 9342 808-5550
Service +49 9342 808-5660

Fax: +49 9342 808-5555

Email: info@vacuubrand.com

Web: www.vacuubrand.com